

NOTES:

1. Double rack holds 4 bicycles.
2. Finish to be weather resistant, baked-on powder polymer coating.
3. Anchor rack to concrete w/ 3/8" ϕ x 2 1/2" wedge anchors and tamper resistant or welded nuts, (4 Req'd) or set tubing 12" below grade in 24" deep x 6" wide concrete footing.
4. Concrete base may be covered with turf or decomposed granite.
5. Placement of bicycle rack shall be convenient to main entrance and in a highly visible area.
6. 24" Min. clearance from walls or obstructions including curbs or edge of roadway on both sides and back of rack. Front of rack shall have a 6' min clear area.

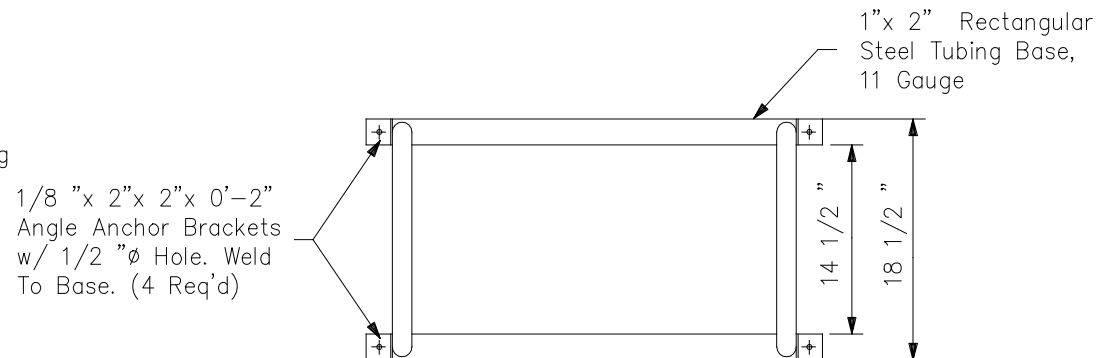
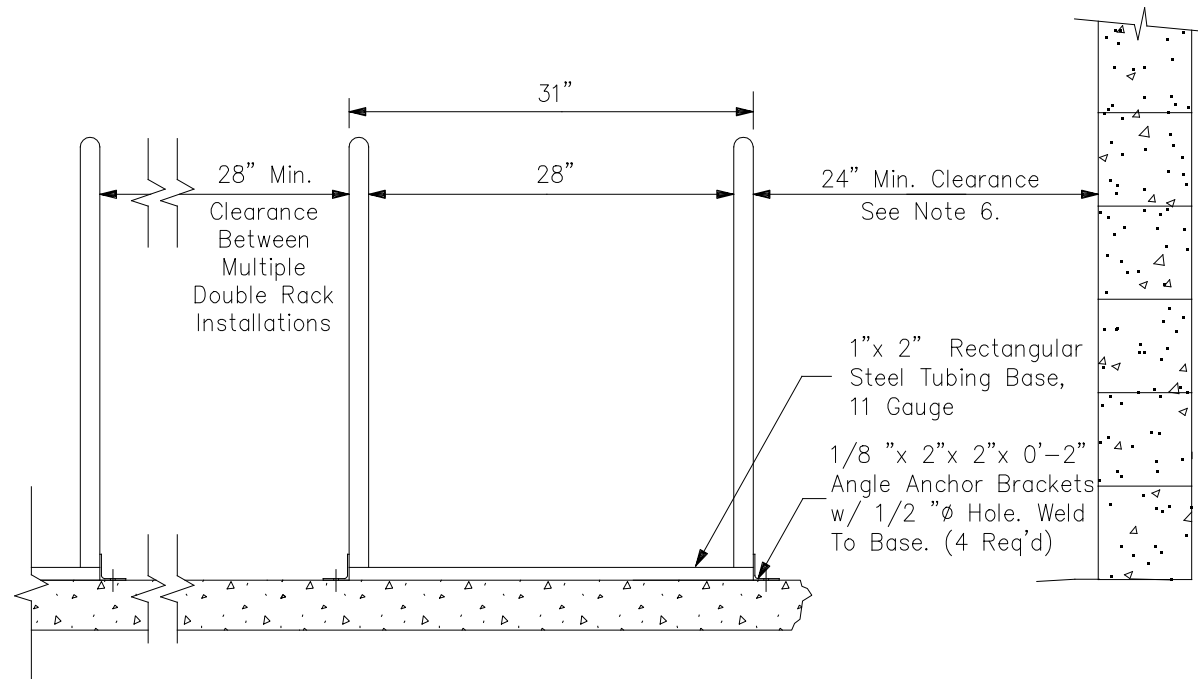

DETAIL NO. 2285	City of Scottsdale Standard Details	APPROVED BY: Scottsdale Standards & Specifications Committee	DOUBLE BICYCLE RACK	DETAIL NO. 2285
---------------------------	--	--	----------------------------	---------------------------