

CITY COUNCIL REPORT



Meeting Date: October 21, 2014
General Plan Element: *Land Use*
General Plan Goal: *Support a diversity of businesses.*

ACTION

Restaurant Liquor License Request for Park Place Bar & Grill 92-LL-2014. To consider forwarding a recommendation of approval to the Arizona Department of Liquor Licenses and Control for a Series 12 (restaurant) State liquor license for an existing location and new owner.

OWNER

Tristan Paul ENT LLC

APPLICANT CONTACT

Paul Samuel Mitchell

LOCATION

7373 Scottsdale Mall #6

BACKGROUND

This request is for a Series 12 (restaurant) liquor license. This has been a licensed location since 2004, most recently operating with liquor as Orange Table.

The zoning for this site is Downtown/Retail Specialty Type-1 Downtown Overlay (D/RS-1 DO), which allows restaurants. This establishment is 2,550 sq. ft. including an existing 750 sq. ft. patio.

APPLICANT'S PROPOSAL

The applicant is seeking a favorable recommendation on a Series 12 (restaurant) liquor license. This allows the holder of a restaurant license to sell and serve spirituous liquor solely for consumption on the premises of an establishment which derives at least forty percent (40%) of its total revenue from the sale of food. The applicant has indicated that this establishment will serve liquor between the hours of 10:00 a.m. to 4 p.m. Sunday through Saturday; however, due to State liquor license

Action Taken _____

processing requirements, they are not required to notify the City or the State if they change their hours of operation.

PETITIONS FROM PERSONS IN CLOSE PROXIMITY

The applicant has maintained the required posting notice for the State mandated 20-day period. No petitions or protests pursuant to A.R.S. 4-201.b. were received during the 20 (twenty) day posting period.

OTHER LICENSES & PERMITS

Financial Management

Revenue Collection has reported that the applicant has met City licensing requirements and all fees have been paid.

Spirituosous Liquor Tax Permit # Pending.

Scottsdale Transaction Privilege Sales Tax License # Pending.

IMPACT ANALYSIS

Current Planning Department.

There will not be any significant changes to the floor plan.

A.R.S. Section 4-112.B.1 R19-1-310 Criteria for Restaurant Operations.

This owner intends to continue operating this location as a restaurant. Staff has assessed the applicant's responses to the State's Restaurant Operation Plan categories: Personnel, Equipment, Menu, Live Entertainment, Bar Games/Televisions, Name of Establishment, Bar Seating Area and Dinnerware. Staff finds that the establishment is designed and intended to operate as a restaurant. The bar service area is 100 sq. ft. (6%) of gross floor area, and the kitchen area is 800 sq. ft. (45%) of the gross floor area. The operational characteristics and floor plan qualify as a restaurant.

Public Safety Division.

Police Department: Recommendation No Opposition

Major life safety issues: None noted.

Code Enforcement: There are no current cases of code violations at this time relevant to the liquor license.

STATE GUIDELINES FOR CONSIDERING AN APPLICATION

A.R.S. Section 4-203.A Granting a License for a New Owner for a Certain Location.

A spirituosous liquor license shall be issued only after satisfactory showing of the capability, qualifications and reliability of the applicant.

COUNCIL OPTIONS & STAFF RECOMMENDATION

Council Options

The City Council has the option of recommending approval, denial or no recommendation to the Arizona Department of Liquor Licenses and Control.

Staff Recommendation

The City of Scottsdale staff has conducted a review and advises that the license request meets the criteria imposed for determining the capability, qualifications and reliability of the applicant.

Next Steps

The City Council's recommendation of approval, denial or no recommendation will be forwarded to the Department of Liquor Licenses and Control for their consideration. If the application is approved by the Department of Liquor Licenses and Control, the applicant should receive their license from the State within 105 days of original application.

RESPONSIBLE DEPARTMENT(S)

Teri Gleason, Planning Assistant, tgleason@scottsdaleaz.gov
Planning and Development Services

James Wasson, Lieutenant, Special Assignment, jwasson@scottsdaleaz.gov
Public Safety Division

Raun Keagy, Neighborhood Planning Director, rkeagy@scottsdaleaz.gov
Planning and Development Services

APPROVED BY



Tim Curtis, ACP, Current Planning Director
480-312-4210, tcurtis@scottsdaleaz.gov

9/24/2014

Date



Randy Grant, Director
Planning and Development Services
480-312-2664, rgrant@scottsdaleaz.gov

9/29/14

Date

ATTACHMENTS

- #1: Aerial Map
- #2: Close-up Aerial Map
- #3: City of Scottsdale Applicant Questionnaire
- #4: State Application







Liquor License Questionnaire

Restaurants & Bars (Series 11, 12, 6, 3, 7, 13)

Please complete all questions and return within 3 business days.

Name of Business: Tristan Paul Ent dba Park Place

Business Address: 7373 Scottsdale Mall, Scottsdale AZ 85251

Total Gross Square Footage of Establishment: 1800

Was liquor sold at this location prior to this application? ☒ Yes ☐ No

If **yes**, what type of license? Series 12

Is this business currently open? ☐ Yes ☒ No

If **yes**, is this business operating with an Interim license? ☒ Yes ☐ No

If **no**, what is the proposed opening date? October 6, 2014

Is this business under construction or being remodeled? ☒ Yes ☐ No

Does this business have an existing patio? ☒ Yes ☐ No Dimensions of patio 25'x30'x25'

Does this business have a proposed patio? ☐ Yes ☐ No Dimensions of patio _____

For Restaurants, Bars and Restaurants/Bars:

Will the bar service area be in excess of 15% of the gross floor area? ☐ Yes* ☒ No

Gross square footage of bar service area: 225

(includes the floor area under indoor and outdoor bars and the floor area behind the bars used for storage, prep and serving of food or drinks)

Will the kitchen be less than 15% of the gross floor area? ☐ Yes* ☒ No

Gross square footage of kitchen: 800

(do not include refrigerators or areas used for storage of food or beverages)

During what hours will the establishment provide full kitchen service? 7AM - 10PM

During what hours will the establishment offer liquor sales? 7 AM - 12:00 AM S,M,T, W 7AM-2AM Th F Sat

Will age verification be required/requested **for admittance** at any time during business operations? ☐ Yes* ☒ No

Is a cover charge required for admittance at any time during business operations? ☐ Yes* ☒ No

Will less than 40% of gross revenues be derived from the sale of prepared food? ☐ Yes* ☒ No

***May require a Conditional Use Permit**

Please check **one** of the following that best describes the primary business operation:

☐ packaged retail ☒ restaurant ☐ bar ☐ personal service

☐ education service ☐ manufacturing ☐ hotel/tourist accommodations

Planning and Development Services

7447 E. Indian School Road, Suite 105, Scottsdale, AZ 85251 ♦ Phone: 480-312-7000 ♦ Fax: 480-312-7088



Liquor License Questionnaire

Restaurants & Bars (Series 11, 12, 6, 3, 7, 13)

Please complete all questions and return within 3 business days.

Will this business feature any of the following:

Patron Dancing?	<input type="checkbox"/> Yes*	<input checked="" type="checkbox"/> No	Karaoke?	<input type="checkbox"/> Yes*	<input checked="" type="checkbox"/> No
Live Bands?	<input type="checkbox"/> Yes*	<input checked="" type="checkbox"/> No	DJ?	<input type="checkbox"/> Yes*	<input checked="" type="checkbox"/> No
Amplified music?	<input type="checkbox"/> Yes*	<input checked="" type="checkbox"/> No	Games?	<input type="checkbox"/> Yes*	<input checked="" type="checkbox"/> No
Adult Entertainment?	<input type="checkbox"/> Yes*	<input checked="" type="checkbox"/> No	Four or more pool tables?	<input type="checkbox"/> Yes*	<input checked="" type="checkbox"/> No
After hours?	<input type="checkbox"/> Yes*	<input checked="" type="checkbox"/> No			

*May require a Conditional Use Permit

Applicant Narrative:

ARS 4-201-G: In all proceedings before the governing body of a city or town, the Board of Supervisors of a County or the Board, the applicant bears the burden of showing that the public convenience requires and that the best interest of the community will be substantially served by the issuance of this license.

1. I have the capability, qualifications and reliability to hold a liquor license because:

I have an existing bar and liquor license. The Tavern is run efficiently and is clean causing no problems the area or city. It is maintained both inside and out on a daily basis. It has become a neighborhood Tavern

2. The public convenience requires and the best interest of the community will be substantially served by the issuance of the liquor license because:

The establishment had a liquor license we are now doing a complete remodel to not only improve the condition of the restaurant but increase awareness to the community of another fine eating establishment. It has a reputation for home cooked food and we will only improve on all the assets that have been established

3. Please describe your business:

It will be a place serving home made breakfasts, lunch and appetizers along with drinks

The City's forwarding of a recommendation to the AZ Department of Liquor Licenses and Control does not waive and is not a substitute for the Licensee's obligation to comply with all state, local and federal laws, policies and regulations applicable to the license. The Recommendation is not a permit or regulatory approval to hold any events or construct or demolish any improvements. Zoning processes, building permit processes, and similar regulatory requirements may apply to Licensee's contemplated Improvements and are completely separate from the Recommendation. Licensee shall be responsible to, separate and apart from this Recommendation, directly obtain all necessary permits and approvals from any and all governmental or other entities including the City's having standing or jurisdiction over the subject areas. For more information regarding zoning processes, building permit processes, and similar regulatory requirements and approvals please call 480-312-2611.

Print Name: PAUL S MITCHELL Signature: [Signature] 480 215 9987 Date: 9.15.14

Submit

Planning and Development Services

7447 E. Indian School Road, Suite 105, Scottsdale, AZ 85251 ♦ Phone: 480-312-7000 ♦ Fax: 480-312-7088

14 SEP 5 Lic. Lic. #1056

Arizona Department of Liquor Licenses and Control
800 West Washington, 5th Floor
Phoenix, Arizona 85007
www.azliquor.gov
602-542-5141

APPLICATION FOR LIQUOR LICENSE
TYPE OR PRINT WITH **BLACK INK**

92-LL-2014

Notice: Effective Nov. 1, 1997, **All Owners, Agents, Partners, Stockholders, Officers, or Managers** actively involved in the day to day operations of the business must attend a Department approved liquor law training course or provide proof of attendance within the last five years. See page 5 of the Liquor Licensing requirements.

SECTION 1 This application is for a:

- ☐ MORE THAN ONE LICENSE
☒ INTERIM PERMIT **Complete Section 5**
☒ NEW LICENSE **Complete Sections 2, 3, 4, 13, 14, 15, 16**
☐ PERSON TRANSFER (Bars & Liquor Stores ONLY)
Complete Sections 2, 3, 4, 11, 13, 15, 16
☐ LOCATION TRANSFER (Bars and Liquor Stores ONLY)
Complete Sections 2, 3, 4, 12, 13, 15, 16
☐ PROBATE/WILL ASSIGNMENT/DIVORCE DECREE
Complete Sections 2, 3, 4, 9, 13, 16 (fee not required)
☐ GOVERNMENT **Complete Sections 2, 3, 4, 10, 13, 15, 16**

SECTION 2 Type of ownership:

- ☐ J.T.W.R.O.S. **Complete Section 6**
☐ INDIVIDUAL **Complete Section 6**
☐ PARTNERSHIP **Complete Section 6**
☐ CORPORATION **Complete Section 7**
☒ LIMITED LIABILITY CO. **Complete Section 7**
☐ CLUB **Complete Section 8**
☐ GOVERNMENT **Complete Section 10**
☐ TRUST **Complete Section 6**
☐ OTHER (Explain) _____

SECTION 3 Type of license and fees LICENSE #(s): RESTAURANT

1207A031

1. Type of License(s): SERIES 12

2. Total fees attached:

Department Use Only
\$ 272.00

APPLICATION FEE AND INTERIM PERMIT FEES (IF APPLICABLE) ARE NOT REFUNDABLE.

The fees allowed under A.R.S. 44-6852 will be charged for all dishonored checks.

SECTION 4 Applicant

PID61136

1. Owner/Agent's Name: ☒ Mr. MITCHELL PAUL SAMUEL
(Insert one name ONLY to appear on license) Last First Middle
2. Corp./Partnership/L.L.C.: TRISTAN PAUL ENTERPRISES LLC 81053041
(Exactly as it appears on Articles of Inc. or Articles of Org.)
3. Business Name: PARK PLACE Bar & Grill 81011252
(Exactly as it appears on the exterior of premises)
4. Principal Street Location 7373 SCOTTSDALE MALL SUITE 100 SCOTTSDALE MARICOPA 85251
(Do not use PO Box Number) City County Zip
5. Business Phone: 480-424-6819 Daytime Phone: 480-275-9989 Email: PSMICCIO@AOL.COM
6. Is the business located within the incorporated limits of the above city or town? ☒ YES ☐ NO
7. Mailing Address: 8102 E. FOOTHILLS DRIVE SCOTTSDALE AZ 85255
City State Zip
8. Price paid for license only bar, beer and wine, or liquor store: Type _____ \$ _____ Type _____ \$ _____

DEPARTMENT USE ONLY

Fees: \$400.00 Application \$100.00 Interim Permit \$50.00 Site Inspection \$22.00 Finger Prints \$ 272.00
TOTAL OF ALL FEES

Is Arizona Statement of Citizenship & Alien Status For State Benefits complete? ☒ YES ☐ NO

Accepted by: DLW Date: 9/5/14 Lic. # 1207A031

SECTION 5 Interim Permit:

1. If you intend to operate business when your application is pending you will need an Interim Permit pursuant to A.R.S. 4-203.01.
2. There **MUST** be a valid license of the same type you are applying for currently issued to the location.
3. Enter the license number currently at the location. 12078763
4. Is the license currently in use? ☒ YES ☐ NO If no, how long has it been out of use? _____

ATTACH THE LICENSE CURRENTLY ISSUED AT THE LOCATION TO THIS APPLICATION.

I, Craig Grant Pierson, declare that I am the CURRENT OWNER, AGENT, CLUB MEMBER, PARTNER,
(Print full name)
MEMBER, STOCKHOLDER, OR LICENSEE (circle the title which applies) of the stated license and location.

x see attached lease agreement
(Signature) & letter from landlord

My commission expires on: _____

State of _____ County of _____

The foregoing instrument was acknowledged before me this

____ day of _____, _____
Day Month Year

(Signature of NOTARY PUBLIC)

SECTION 6 Individual or Partnership Owners:

EACH PERSON LISTED MUST SUBMIT A COMPLETED QUESTIONNAIRE (FORM LIC0101), AN "APPLICANT" TYPE FINGERPRINT CARD, AND \$22 PROCESSING FEE FOR EACH CARD.

1. Individual:

Last	First	Middle	% Owned	Mailing Address	City State Zip

Partnership Name: (Only the first partner listed will appear on license) _____

General-Limited	Last	First	Middle	% Owned	Mailing Address	City State Zip
<input type="checkbox"/>	<input type="checkbox"/>					
<input type="checkbox"/>	<input type="checkbox"/>					
<input type="checkbox"/>	<input type="checkbox"/>					
<input type="checkbox"/>	<input type="checkbox"/>					

) Y R A S S E C E N F I T

2. Is any person, other than the above, going to share in the profits/losses of the business? ☐ YES ☐ NO
If Yes, give name, current address and telephone number of the person(s). Use additional sheets if necessary.

Last	First	Middle	Mailing Address	City, State, Zip	Telephone#

STATE OF ARIZONA
DEPARTMENT OF LIQUOR LICENSES
AND CONTROL
ALCOHOLIC BEVERAGE LICENSE
License 12078763

Issue Date: 9/9/2011

Expiration Date: 3/31/2015

Issued To:

CRAIG GRANT PIERSON, Agent
OT SCOTTSDALE LLC, Owner

Restaurant

Location:

ORANGE TABLE
7373 E SCOTTSDALE MALL #6
SCOTTSDALE, AZ 85251

Mailing Address:

CRAIG GRANT PIERSON
OT SCOTTSDALE LLC
ORANGE TABLE
7373 E SCOTTSDALE MALL #6
SCOTTSDALE, AZ 85251



POST THIS LICENSE IN A CONSPICUOUS PLACE

14 SEP 5 11 PM '11



SETTING THE STANDARD

2101 W. GALVESTON STREET
CHANDLER, ARIZONA 85224
Phone: 480-567-5183
E-Fax: 1-866-576-1349
Email: bill@touchstonerealty.biz

14 SEP 5 11:49 AM '10

September 3, 2014

TO WHOM IT MAY CONCERN

Subject: Park Place (Formerly Orange Table) at 7373 Scottsdale Mall

Touchstone Realty, LLC, is the leasing agent for the property at 7373 Scottsdale Mall, Scottsdale, Arizona, 85251. We have recently contracted a lease agreement with Mr. Paul Mitchell, dba Tristan Paul Ent., for the space and business formerly owned and managed by OT Scottsdale LLC and known as The Orange Table. Mr. Mitchell is in the process of changing the name of the business to Park Place, but has essentially taken over ownership and management of the existing business in its established location.

Please feel free to contact us if you desire additional information or clarification.

Respectfully,

A handwritten signature in black ink, appearing to read "William J. Williams, Jr.", written over a horizontal line.

William J. Williams, Jr., Designated Broker
Touchstone Realty, LLC

SECTION 7 Corporation/Limited Liability Co.:

EACH PERSON LISTED MUST SUBMIT A COMPLETED QUESTIONNAIRE (FORM LIC0101), AN "APPLICANT" TYPE FINGERPRINT CARD, AND \$22 PROCESSING FEE FOR EACH CARD.

☐ CORPORATION **Complete questions 1, 2, 3, 5, 6, 7, and 8.**

☒ L.L.C. **Complete 1, 2, 4, 5, 6, 7, and 8.**

1. Name of Corporation/L.L.C.: TRISTAN PAUL ENT LLC

(Exactly as it appears on Articles of Incorporation or Articles of Organization)

2. Date Incorporated/Organized: 7-10-2014 State where Incorporated/Organized: ARIZONA

3. AZ Corporation Commission File No.: L19383029 Date authorized to do business in AZ: _____

4. AZ L.L.C. File No: L19383029 Date authorized to do business in AZ: AUG 1 2014

5. Is Corp./L.L.C. Non-profit? ☐ YES ☒ NO

6. List all directors, officers and members in Corporation/L.L.C.

Last	First	Middle	Title	Mailing Address	City	State	Zip
MITCHELL	PAUL	SAMUEL	MANAGER	8102 EAST FOOTHILLS DRIVE	SCOTTSDALE	AZ	85255

(ATTACH ADDITIONAL SHEET IF NECESSARY)

7. List stockholders who are controlling persons or who own 10% or more:

Last	First	Middle	% Owned	Mailing Address	City	State	Zip
NOT APPLICABLE							
MITCHELL	PAUL	SAMUEL	100%	8102 E. FOOTHILLS DR.	SCOTTSDALE	AZ	85255

(ATTACH ADDITIONAL SHEET IF NECESSARY)

8. If the corporation/L.L.C. is owned by another entity, attach a percentage of ownership chart, and a director/officer/member disclosure for the parent entity. Attach additional sheets as needed in order to disclose personal identities of all owners.

SECTION 8 Club Applicants:

EACH PERSON LISTED MUST SUBMIT A COMPLETED QUESTIONNAIRE (FORM LIC0101), AN "APPLICANT" TYPE FINGERPRINT CARD, AND \$22 PROCESSING FEE FOR EACH CARD.

1. Name of Club: _____ Date Chartered: _____

(Exactly as it appears on Club Charter or Bylaws)

(Attach a copy of Club Charter or Bylaws)

2. Is club non-profit? ☐ YES ☐ NO

3. List officer and directors:

Last	First	Middle	Title	Mailing Address	City	State	Zip

(ATTACH ADDITIONAL SHEET IF NECESSARY)

SECTION 9 Probate, Will Assignment or Divorce Decree of an existing Bar or Liquor Store License:

1. Current Licensee's Name: _____
(Exactly as it appears on license) Last First Middle
2. Assignee's Name: _____
Last First Middle
3. License Type: _____ License Number: _____ Date of Last Renewal: _____
4. ATTACH TO THIS APPLICATION A CERTIFIED COPY OF THE WILL, PROBATE DISTRIBUTION INSTRUMENT, OR DIVORCE DECREE THAT SPECIFICALLY DISTRIBUTES THE LIQUOR LICENSE TO THE ASSIGNEE TO THIS APPLICATION.

SECTION 10 Government: (for cities, towns, or counties only)

1. Governmental Entity: _____
2. Person/designee: _____
Last First Middle Contact Phone Number

A SEPARATE LICENSE MUST BE OBTAINED FOR EACH PREMISES FROM WHICH SPIRITUOUS LIQUOR IS SERVED.

SECTION 11 Person to Person Transfer:

Questions to be completed by CURRENT LICENSEE (Bars and Liquor Stores ONLY-Series 06,07, and 09).

1. Current Licensee's Name: _____ Entity: _____
(Exactly as it appears on license) Last First Middle (Indiv., Agent, etc.)
2. Corporation/L.L.C. Name: _____
(Exactly as it appears on license)
3. Current Business Name: _____
(Exactly as it appears on license)
4. Physical Street Location of Business: Street _____
City, State, Zip _____
5. License Type: _____ License Number: _____
6. If more than one license to be transferred: License Type: _____ License Number: _____
7. Current Mailing Address: Street _____
(Other than business) City, State, Zip _____
8. Have all creditors, lien holders, interest holders, etc. been notified of this transfer? ☐ YES ☐ NO
9. Does the applicant intend to operate the business while this application is pending? ☐ YES ☐ NO If yes, complete Section 5 of this application, attach fee, and current license to this application.

10. I, _____, hereby authorize the department to process this application to transfer the
(print full name)
privilege of the license to the applicant, provided that all terms and conditions of sale are met. Based on the fulfillment of these conditions, I certify that the applicant now owns or will own the property rights of the license by the date of issue.

I, _____, declare that I am the CURRENT OWNER, AGENT, MEMBER, PARTNER
(print full name)
STOCKHOLDER, or LICENSEE of the stated license. I have read the above Section 11 and confirm that all statements are true, correct, and complete.

(Signature of CURRENT LICENSEE)

State of _____ County of _____
The foregoing instrument was acknowledged before me this

My commission expires on: _____

Day Month Year

(Signature of NOTARY PUBLIC)

SECTION 12 Location to Location Transfer: (Bars and Liquor Stores ONLY)**APPLICANTS CANNOT OPERATE UNDER A LOCATION TRANSFER UNTIL IT IS APPROVED BY THE STATE**

1. Current Business: Name _____
(Exactly as it appears on license) Address _____
2. New Business: Name _____
(Physical Street Location) Address _____
3. License Type: _____ License Number: _____
4. If more than one license to be transferred: License Type: _____ License Number: _____
5. What date do you plan to move? _____ What date do you plan to open? _____

SECTION 13 Questions for all in-state applicants excluding those applying for government, hotel/motel, and restaurant licenses (series 5, 11, and 12):

A.R.S. § 4-207 (A) and (B) state that no retailer's license shall be issued for any premises which are at the time the license application is received by the director, within three hundred (300) horizontal feet of a church, within three hundred (300) horizontal feet of a public or private school building with kindergarten programs or grades one (1) through (12) or within three hundred (300) horizontal feet of a fenced recreational area adjacent to such school building. The above paragraph DOES NOT apply to:

- a) Restaurant license (§ 4-205.02) c) Government license (§ 4-205.03)
b) Hotel/motel license (§ 4-205.01) d) Fenced playing area of a golf course (§ 4-207 (B)(5))

4-207 5 Lic. Lic. #1057

1. Distance to nearest school: 10420 ft. Name of school OUR LADY OF PERPETUAL HELP
Address SCOTTSDALE AZ 85251
City, State, Zip
2. Distance to nearest church: 10420 ft. Name of church OUR LADY OF PERPETUAL HELP
Address SCOTTSDALE AZ 85251
City, State, Zip
3. I am the: ☒ Lessee ☐ Sublessee ☐ Owner ☐ Purchaser (of premises)
4. If the premises is leased give lessors: Name 7373 SCOTTSDALE MALL 40 PROPERTY ACCOUNTING SERVICES
Address 428 E. THUNDERBIRD #445 PHX. AZ 85022
City, State, Zip
- 4a. Monthly rental/lease rate \$ 4500.00 What is the remaining length of the lease 4 yrs. 10 mos.
- 4b. What is the penalty if the lease is not fulfilled? \$ 203,200.00 or other _____
(give details - attach additional sheet if necessary)
5. What is the total **business** indebtedness for this license/location excluding the lease? \$ 95,000
Please list lenders you owe money to.

Last	First	Middle	Amount Owed	Mailing Address	City State	Zip
PIERSON	CRAIG	GRANT	31666 ⁶⁰	3902N BROWN AVE #101	Scottsdale	85251
PIERSON	ALLISSA		31666 ⁶⁰	3902N BROWN AVE #101	Scottsdale	85251
MCCURLEY	MATTHEW		31666 ⁶⁰	3902N BROWN AVE #101	Scottsdale	85251

(ATTACH ADDITIONAL SHEET IF NECESSARY)

6. What type of business will this license be used for (be specific)? RESTAURANT AND BAR

SECTION 13 - continued

7. Has a license or a transfer license for the premises on this application been denied by the state within the past one (1) year?

☐ YES ☒ NO If yes, attach explanation.

8. Does any spirituous liquor manufacturer, wholesaler, or employee have any interest in your business? ☐ YES ☒ NO

9. Is the premises currently licensed with a liquor license? ☒ YES ☐ NO If yes, give license number and licensee's name:

License # 12078763 (exactly as it appears on license) Name CRAIG GRANT PIERSON
AT SLOTT'S DATE, LLC
(UHS)

SECTION 14 Restaurant or hotel/motel license applicants:

1. Is there an existing restaurant or hotel/motel liquor license at the proposed location? ☒ YES ☐ NO
If yes, give the name of licensee, Agent or a company name:

PIERSON CRAIG GRANT and license #: 12078763
Last First Middle

2. If the answer to Question 1 is YES, you may qualify for an Interim Permit to operate while your application is pending; consult A.R.S. § 4-203.01; and complete SECTION 5 of this application.

3. All restaurant and hotel/motel applicants must complete a Restaurant Operation Plan (Form LIC0114) provided by the Department of Liquor Licenses and Control.

4. As stated in A.R.S. § 4-205.02.G.2, a restaurant is an establishment which derives at least 40 percent of its gross revenue from the sale of food. Gross revenue is the revenue derived from all sales of food and spirituous liquor on the licensed premises. By applying for this ☐ hotel/motel ☒ restaurant license, I certify that I understand that I must maintain a minimum of 40 percent food sales based on these definitions and have included the Restaurant Hotel/Motel Records Required for Audit (form LIC 1013) with this application.

[Signature]

applicant's signature

As stated in A.R.S. § 4-205.02 (B), I understand it is my responsibility to contact the Department of Liquor Licenses and Control to schedule an inspection when all tables and chairs are on site, kitchen equipment, and, if applicable, patio barriers are in place on the licensed premises. With the exception of the patio barriers, these items are not required to be properly installed for this inspection. Failure to schedule an inspection will delay issuance of the license. If you are not ready for your inspection 90 days after filing your application, please request an extension in writing, specify why the extension is necessary and the new inspection date you are requesting. To schedule your site inspection visit www.azliquor.gov and click on the "Information" tab.

[Signature]
applicants initials

SECTION 15 Diagram of Premises: (Blueprints not accepted, diagram must be on this form)

1. Check ALL boxes that apply to your business:

☒ Entrances/Exits ☒ Liquor storage areas Patio: ☒ Contiguous
☐ Service windows ☐ Drive-in windows ☐ Non Contiguous

2. Is your licensed premises currently closed due to construction, renovation, or redesign? ☒ YES ☐ NO
If yes, what is your estimated opening date? OCTOBER 6, 2014
month/day/year

3. Restaurants and hotel/motel applicants are required to draw a detailed floor plan of the kitchen and dining areas including the locations of all kitchen equipment and dining furniture. Diagram paper is provided on page 7.

4. The diagram (a detailed floor plan) you provide is required to disclose only the area(s) where spiritous liquor is to be sold, served, consumed, dispensed, possessed, or stored on the premises unless it is a restaurant (see #3 above).

5. Provide the square footage or outside dimensions of the licensed premises. Please do not include non-licensed premises, such as parking lots, living quarters, etc.

As stated in A.R.S. § 4-207.01(B), I understand it is my responsibility to notify the Department of Liquor Licenses and Control when there are changes to boundaries, entrances, exits, added or deleted doors, windows or service windows, or increase or decrease to the square footage after submitting this initial drawing.

[Signature]
applicants initials

SECTION 15 Diagram of Premises

4. In this diagram please show only the area where spirituous liquor is to be sold, served, consumed, dispensed, possessed or stored. It must show all entrances, exits, interior walls, bars, bar stools, hi-top tables, dining tables, dining chairs, the kitchen, dance floor, stage, and game room. Do not include parking lots, living quarters, etc. When completing diagram, North is up ↑.

If a legible copy of a rendering or drawing of your diagram of premises is attached to this application, please write the words "diagram attached" in box provided below.

SEE DRAWING & 3 D DRAWING

14 SEP 5 11:47 AM 1057

SECTION 16 Signature Block

I, PAUL SANDEL MITCHELL, hereby declare that I am the OWNER/AGENT filing this application as stated in Section 4, Question 1. I have read this application and verify all statements to be true, correct and complete.

X [Signature]
(signature of applicant listed in Section 4, Question 1)

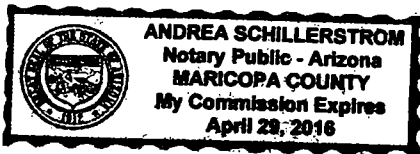

State of Arizona County of Maricopa

The foregoing instrument was acknowledged before me this 2nd of September, 2014
Day Month Year

My commission expires on: April 28, 2016
Day Month Year

[Signature]
signature of NOTARY PUBLIC

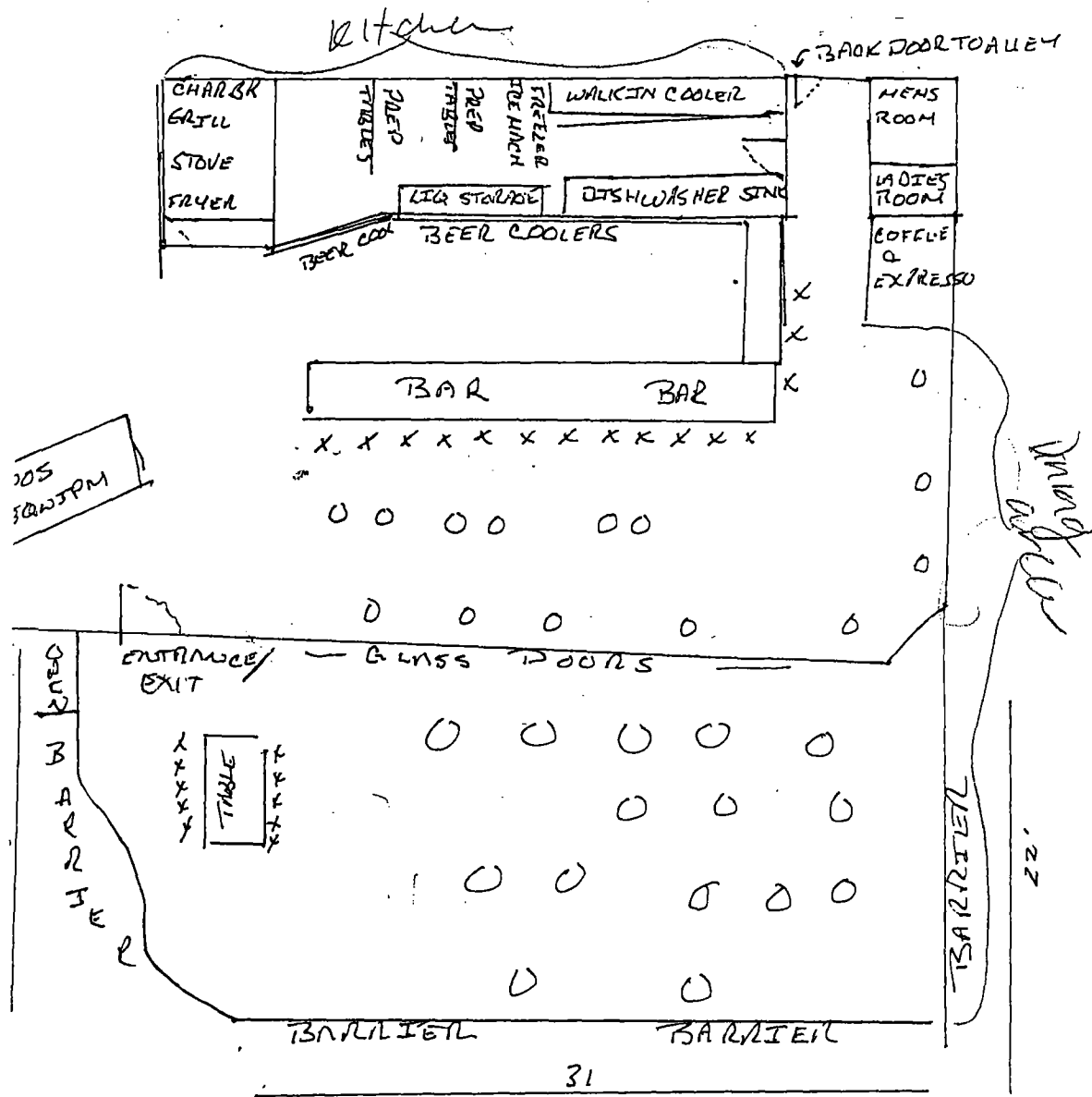

O TABLES
X BAR STOOLS

1800 total Sq. Ft.

14 SEP 5 11:41 AM '58

omelettes/scrambles/eggs*

choice of toast

greek	10.50
kalamatas + artl hearts + pepperoncini + goat feta + tomatoes + onions	
garlic mushroom	11.50
crimini mushrooms + swiss, mushroom sherry cream sauce	
MONACO	10.50
roasted red bells + provolone	
hatch	10.50
roasted green chills + chicken + provolone + onion	
catalan	11.50
schreiner's chorizo + kalamatas + provolone + tomatoes + onions	9.50
two egg breakfast	
two eggs any style + breakfast potatoes + bacon, sausage, prosciutto cotto or fruit, choice of toast	
chimichurri steak + eggs	14
grilled steak + chimichurri sauce + 2 eggs any style + breakfast potatoes, choice of toast	
egg sandwich*	7
two eggs over easy or omelette style + cheddar, swiss or provolone, sourdough	
+ bacon, sausage or prosciutto	3

sides/desserts

weske's bacon	4.00
schreiner's sausage	4.00
grilled chicken	4.00
sirloin steak	5.00
breakfast potatoes	3.00
corned beef hash	4.00
prosciutto	4.00

assorted daily pastry Mkt

*eggs, meat & seafood are cooked to order, consuming raw or undercooked food such as eggs, meat or fish may increase the risk of food borne illness

salads/soups

greek	12
mixed greens + kalamatas + cerignolas + artl hearts + pepperoncini + roasted beets + goat feta + radish + tomatoes + cucumbers + red onion, greek dress, choice of bread	
+ chicken	3
mozzarella	10
house pulled mozz + mixed greens + tomatoes + basil + sliced garlic, balsamic dressing	
choice of bread	+ prosciutto 4
nicoise*	14
seared ahi + mixed greens + kalamatas + haricots verts + hard eggs + potatoes + tomatoes + cucumber, nicoise dress, choice of bread	
cranberry + bleu	11
mixed greens + dried crans + bleu + toasted pecans + tomatoes + cucumbers, balsamic dressing, choice of bread	
spinach	10
spinach + hard eggs + tomatoes + cucumbers + red onion, warm bacon dress, choice of bread	+ steak 5
greek	5/9
mixed greens + carrot + sprouts + radish + tomatoes + cucumbers + red onion, choice of dress, choice of bread	+ chicken 3
hummus plate	10
house hummus + kalamatas + cerignolas + cornichons + tomatoes + cucumbers, pita chips	
soup du jour	
cup 4.00 bowl 5.50	
cup + 1/2 sandwich or sm green salad (chicken salad, veggie, café, blt)	9

14 SEP 5 11:41 PM '15

*eggs, meat & seafood are cooked to order, consuming raw or undercooked food such as eggs, meat or fish may increase the risk of food borne illness

call for delivery

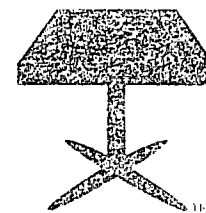

call 480.424.6819

coffeehouse + bar + griddle

Rink Place Bar & Grill

full menu served 7 a - 3 p

oranjatableaz.com

7373 east scottsdale mall #105 480.424.6819

available for private parties + special events + catering + delivery

delivery available - subject to min \$ and availability

pancakes/french toast

Including bacon, sausage, prosciutto or fruit

jalapeno pecan cakes	11.50
jalapenos + pecans + jalapeno + pecan pan syrup	
wildberry cakes	12.75
strawberries + blueberries, raspberries + berry pan syrup	
monkey cakes	11.50
bananas + almonds + coconut	
banana nut cakes	12.50
bananas + pecans + 100% maple syrup	
basic buttermilk cakes	9.75
2 cakes + butter + 100% maple syrup	
bananas foster french toast	14
traditional + bananas + pecans, spicebox whiskey sauce	
traditional french toast	9.75
4 slices + butter, 100% maple syrup	

ménage* 11.50
2 eggs any style + large cake + bacon, sausage, prosciutto, or fruit

+ specialty cake 1.50

brunch burger* 11
1/2 lb angus + hash + fried egg
maple mayo + grilled bun

light fare

fruit plate	9.75
seasonal fruit + honey infused yogurt + choice of toast	
granola yogi	6.50
seasonal fruit + honey infused yogurt + house granola	
fruit yogi	5.50
seasonal fruit + honey infused yogurt	
fruit cup	4

flannels*

2 eggs any style, choice of toast

green flannel	10.50
corned beef + roasted green chilis + jalapenos + green bells + potatoes + topped with sour cream	
white flannel	10.50
corned beef + mushrooms + onion + potatoes + topped with sour cream	
red flannel	11
corned beef + roasted beets + potatoes + topped with sour cream	

hashes*

2 eggs any style, choice of toast

corned beef hash	9.75
corned beef + potatoes	
veggie hash	10.75
kalamatas + haricots verts + roasted beets + green bells + tomatoes + onions + potatoes	
monaco hash	11.75
corned beef + roasted red bells + potatoes + provolone	
chimichurri hash	11.75
corned beef hash + chimichurri	

sandwiches

california tuna*	13
seared ahi + avocado + sprouts + tomato + red onion, house horseradish + dill mayo, grilled bun	
green chili cheddar chicken melt	11
grilled chicken + roasted green chilis + cheddar + tomato + red onion + lettuce, mayo, grilled bun	
reuben	10.75
grilled corned beef + house sauerkraut + swiss, house russian dress, toasted rye	
bit	9.75
nueske's bacon + lettuce + tomato, mayo, toasted sourdough	
cafe	9.50
house pulled mozz + basil + tomato + cukes + red onion, balsamic dressing, olive bread	
steak + bleu	12
flat iron + sauteed criminis + grilled red onion + bleu, mayo, toasted sourdough	
rustler	10.75
grilled chicken + nueske's bacon + provolone tomato + red onion + lettuce, mayo, house bbq sauce, toasted sourdough	
loki	10.75
grilled corned beef + jalapeno + house pickled red onion + havarti, house horseradish dill mayo, toasted rye	
artisan tuna melt	10.75
grilled tuna salad + provolone + tomato + red onion, pistou, dijon, wheat	

scottsdale's original chipotle chicken melt	10.75
grilled chicken + cheddar + provolone + tomato + red onion + lettuce, house chipotle mayo, grilled sourdough	

chicken salad	9.75
grilled chicken + apple + celery + tomato + lettuce, mayo, wheat	

havarti grilled cheese	9
havarti + grilled tomato, grilled sourdough	

veggie	9.75
house hummus + roasted red bells + avocado + carrot + sprouts + tomato + cukes + red onion, pistou, olive bread	

burgers*

arrogant bastard	12.50
1/2 lb angus beef + nueske's bacon + provolone + tomato + red onion + lettuce, house bbq sauce, mayo, grilled bun	

+ 22 oz bomber of beer 6

belvedere wine	12.50
1/2 lb angus beef + red wine + provolone + tomato + red onion + lettuce, mayo, grilled bun	

green chili cheddar	11.50
1/2 lb angus beef + roasted green chilies + cheddar + avocado + tomato + red onion + lettuce, mayo, grilled bun	

bleu cheese burger	12
1/2 lb angus beef + bleu crumbles + tomato + grilled red onion + lettuce, mayo, grilled bun	

mushroom swiss burger	11.50
1/2 lb angus beef + grilled criminis + swiss + tomato + red onion + lettuce, mayo, grilled bun	

cheeseburger	10.50
1/2 lb angus beef + cheddar + tomato + red onion + lettuce, mayo, grilled bun	

14 SEP 5 11:41 AM '17

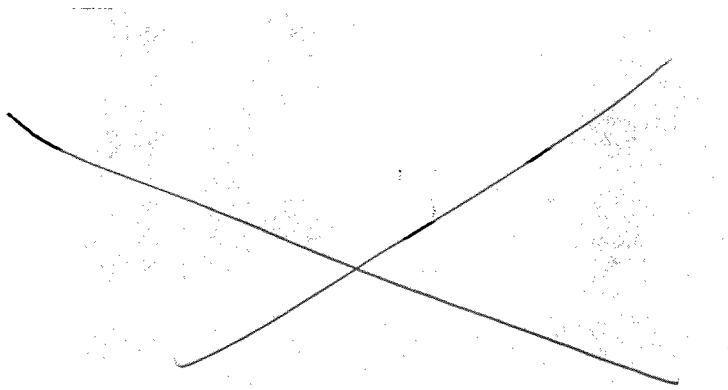

Park Place Bar & Grill

Mexican chocolate latte	3.75
SMoCA mocha	3.75
Chai honey latte (organic fair trade)	3.75
Mojo chai (add 1/2 tsp. honey)	4.25
OT shakerato (1oz. vodka, 1oz. rum, 1oz. amaretto)	5
Add booze + 3	
French press (Serves 2)	6
Cappuccino (espresso, steamed milk, foam)	3.25
Latte (espresso, steamed milk)	3.25
Mocha (espresso, chocolate, steamed milk)	3.75
Poke in the eye (mud, hot chocolate)	3.25
Espresso	2.75
Espresso Americano	2.75
Café au lait (hot, no booze)	2.75
Coffee house (hot, no booze)	2.50
Apricot iced tea	2.50
Hot tea (Assam, Earl Grey)	2.50
Fresh squeezed juice	
Orange + grapefruit	3/3.5/4.25
Lemonade + limeade	2.50
Soft drinks	
San Pellegrino (any flavor)	4.50
Grab + go (any flavor)	2.50
Coffee soda (hot, no booze)	3.50
Add flav + .50	
French soda (any flavor)	3.25
Italian soda (any flavor)	2.75
Just soda (any flavor)	2.50
Milk (whole, 1/2 fat, skim)	2.50
Hot chocolate	3.00

14 SEP 5 11:47 L.L. 8M10:58

COCKTAILS

Breakfast in bed fresh squeezed oj, sailor jerry's spiced rum, butterscotch schnapps and a slice of bacon	9.00
Bloody Mary vodka + ot house bloody concoction + pickled veggies	7.00
Michelada modulo + ot house bloody concoction + salted rim + lime	6.00
Greyhound vodka + fresh squeezed grapefruit	7.00
Screwdriver vodka + fresh squeezed oj	7.00
Moscow mule vodka + ginger beer + copper mug	9.00
Glasgow gin + strawberry + basil + mint + fresh squeezed lime juice	9.00
John daly sweet tea vodka + fresh squeezed lemonade	7.00
Mojito silver rum + mint + fresh squeezed lime juice	8.00
Ginger mojito silver rum + ginger liqueur + mint + fresh squeezed lime + splash of ginger beer	9.00
Shot in the dark chocolate whipped vodka + double shot espresso + house blend coffee	9.00
Old town's best mimosa bubbles + fresh squeezed oj	7.00
Morning glory bubbles + pineapple juice + Cointreau	7.00
Day break bubbles + st. germain elderflower liqueur	7.00
One hope champagne (proceeds benefit breast cancer)	7/28
Cereal shots your choice:	5.00
Fruit Loops rumchata + three olives loopy vodka, Frosty Flakes rumchata + three olives vanilla vodka	
Lucky Charms rumchata + three olives cake vodka, Cinn-a-mon Toast Crunch rumchata + fireball	
Count Vodka rumchata + three olives chocolate vodka, Crushberries rumchata + three olive strawberry vodka	

BEER

Local crafts

Four peaks sunbru light + crisp kolsch with a hint of honey	5.00
Four peaks 8th street malty + hoppy balanced pale ale	5.00
Four peaks kiltlifter malty sweet + smoky Scottish ale	5.00
Nimbus old monkeyshine dark roasted + caramel English ale	5.00
Nimbus brown chocolaty rich + nutty brown ale	5.00
Santan hefeweizen effervescent + sweet Bavarian wheat	5.00
Barrio Blonde light and crisp + very drinkable + one of Tucson's finest	5.00

Other crafts

Dogfish 90 min ipa "perhaps the best ipa in America"	6.00
Hanger 24 orange wheat think light wheat beer with a hint of orange but finishes crisp with little sweetness	5.00
Hanger 24 Helles Lager had enough of hops? Try this helles lager and enjoy the mait side of life	5.00
Stone ipa hops + hops + more hops	5.00
Stone arrogant bastard (22 oz) hoppy + malty aggressive ale	8.00
Lagunitas daytime boldly dosed with glorious dry hops + toasty malt backbone	6.00
Lagunitas pils czech style lager + light + crisp + easy to drink	6.00
Kronenbourg 1664 light + crisp lager	5.00
Delirium Tremens spicy + bitter Belgian strong ale	8.00
Modelo especial rich + full-flavored pilsner	5.00

WINE presented by Sean Minor ask your server for details

Chardonnay, Sauvignon Blanc, other whites	8.00
Cabernet sauvignon, Pinot Noir, other reds	9.00

14 SEP 5 11:41 AM 10:58