

CITY COUNCIL REPORT



Meeting Date: October 8, 2013
General Plan Element: *Land Use*
General Plan Goal: *Support a diversity of businesses*

ACTION

Restaurant Liquor License Request for Los Sombreros Mexican Restaurant 79-LL-2013. To consider forwarding a recommendation to the Arizona Department of Liquor Licenses and Control for a Series 12 (restaurant) State liquor license for an existing location and new owner.

OWNER

Los Sombreros 2, LLC

APPLICANT CONTACT

Azucena Esperanza Tovar

LOCATION

14795 N Northsight Blvd.

BACKGROUND

This request is for a Series 12 (restaurant) liquor license. This has been a licensed location since 2006, most recently operating with liquor as Javinos.

The zoning for this site is Central Business District (C-2), which allows restaurants. This establishment is 4,616 sq. ft. including an existing 562 sq. ft. patio.

APPLICANT'S PROPOSAL

The applicant is seeking a favorable recommendation on a Series 12 (restaurant) liquor license. This allows the holder of a restaurant license to sell and serve spirituous liquor solely for consumption on the premises of an establishment which derives at least forty percent (40%) of its total revenue from the sale of food. The applicant has indicated that this establishment will serve liquor between the hours of 11:00 a.m. to 10:00 p.m.; however, due to State liquor license processing

Action Taken _____

requirements, they are not required to notify the City or the State if they change their hours of operation.

PETITIONS FROM PERSONS IN CLOSE PROXIMITY

The applicant has maintained the required posting notice for the State mandated 20-day period. No petitions or protests pursuant to A.R.S. 4-201.b. were received during the 20 (twenty) day posting period.

OTHER LICENSES & PERMITS

Financial Management

Revenue Collection has reported that the applicant has met City licensing requirements and all fees have been paid.

Spirituous Liquor Tax Permit # Pending.

Scottsdale Transaction Privilege Sales Tax License # Pending.

IMPACT ANALYSIS

Current Planning Department

There will not be any significant changes to the floor plan.

A.R.S. Section 4-112.B.1 R19-1-310 Criteria for Restaurant Operations.

This owner intends to continue operating this location as a restaurant. Staff has assessed the applicant's responses to the State's Restaurant Operation Plan categories: Personnel, Equipment, Menu, Live Entertainment, Bar Games/Televisions, Name of Establishment, Bar Seating Area and Dinnerware. Staff finds that the establishment is designed and intended to operate as a restaurant. The bar service area is 200 sq. ft. (5%) of gross floor area, and the kitchen area is 650 sq. ft. (16%) of the gross floor area. The operational characteristics and floor plan qualify as a restaurant.

Public Safety Division.

Police Department: Recommendation No Opposition

Major life safety issues: None noted.

Code Enforcement: There are no current cases of code violations at this time relevant to the liquor license.

STATE GUIDELINES FOR CONSIDERING AN APPLICATION

A.R.S. Section 4-203.A Granting a License for a New Owner for a Certain Location.

A spirituous liquor license shall be issued only after satisfactory showing of the capability, qualifications and reliability of the applicant.

COUNCIL OPTIONS & STAFF RECOMMENDATION

Council Options

The City Council has the option of recommending approval, denial or no recommendation to the Arizona Department of Liquor Licenses and Control.

Staff Recommendation

The City of Scottsdale staff has conducted a review and advises that the license request meets the criteria imposed for determining the capability, qualifications and reliability of the applicant.

Next Steps

The City Council's recommendation of approval, denial or no recommendation will be forwarded to the Department of Liquor Licenses and Control for their consideration. If the application is approved by the Department of Liquor Licenses and Control, the applicant should receive their license from the State within 105 days of original application.

RESPONSIBLE DEPARTMENT(S)

Teri Gleason, Planning Assistant, tgleason@scottsdaleaz.gov
Planning, Neighborhood and Transportation Division

James Wasson, Lieutenant, Special Assignment, jwasson@scottsdaleaz.gov
Public Safety Division

Raun Keagy, Planning, Neighborhood and Transportation Director, rkeagy@scottsdaleaz.gov
Planning, Neighborhood and Transportation Division

APPROVED BY

Tim Curtis, AICP, Current Planning Director
312-4210 tcurtis@scottsdaleaz.gov

 9/13/2013

Randy Grant, PNT Administrator
312-2664, rgrant@scottsdaleaz.gov



ATTACHMENTS

- #1: Aerial Map
- #2: Close-up Aerial Map
- #3: City of Scottsdale Applicant Questionnaire
- #4: State Application



Q.S.
34-48

G.I.S. ORTHOPHOTO 2012

79-LL-2013

Los Sombreros Mexican Restaurant

ATTACHMENT #1



79-LL-2013

Los Sombreros Mexican Restaurant

ATTACHMENT #2



Liquor License Questionnaire

Please complete all questions and return within 3 business days.

Name of Business: Los Sombros 2 LLC
 Business Address: 14745 N. Northpoint Blvd.
 Type of Business (restaurant, bar, grocery, retail): Restaurant
 Total Gross Square Footage of Establishment: 4,021

Was there a previous business at this location? ☒ Yes ☐ No
 If yes, list the previous business: _____

Was liquor sold at this location prior to this application? ☒ Yes ☐ No
 If yes, what type of license? _____

Is this business currently open? ☐ Yes ☒ No

If yes, is this business operating with an interim license? ☐ Yes ☒ No

If no, what is the proposed opening date? _____

Is this business under construction or being remodeled? ☐ Yes ☒ No

Does this business have an existing patio? ☒ Yes ☐ No Dimensions of patio _____

Does this business have a proposed patio? ☒ Yes ☐ No Dimensions of patio 6 x 20

How many parking spaces are allocated to your business? For waiting (if I am that lucky!)

For Restaurants, Bars and Restaurants/Bars:

Will the bar service area be in excess of 15% of the gross floor area? ☐ Yes* ☒ No

Will the kitchen be less than 15% of the gross floor area? ☐ Yes* ☒ No

Will age verification be required/requested for admittance at any time during business operations? ☐ Yes* ☒ No

Is a cover charge required for admittance at any time during business operations? ☐ Yes* ☒ No

Will less than 40% of gross revenues be derived from the sale of prepared food? ☐ Yes* ☒ No

*May require a Conditional Use Permit

During what hours will the establishment provide full kitchen service? 11-10

During what hours will the establishment offer liquor sales? 11-10

Gross square footage of kitchen: 650 sq ft

(do not include refrigerators or areas used for storage of food or beverages)

Gross square footage of bar service area: 200 sq ft

(includes the floor area under indoor and outdoor bars and the floor area behind the bars used for storage, prep and serving of food or drinks)

Planning, Neighborhood and Transportation Division

7447 E. Indian School Road, Suite 105, Scottsdale, AZ 85251 • Phone: 480-312-700



Liquor License Questionnaire

Please complete all questions and return within 3 business days.

Will this business feature any of the following:

Patron Dancing?	<input type="checkbox"/> Yes*	<input checked="" type="checkbox"/> No	Karaoke?	<input type="checkbox"/> Yes*	<input checked="" type="checkbox"/> No
Live Bands?	<input type="checkbox"/> Yes*	<input checked="" type="checkbox"/> No	DJ?	<input type="checkbox"/> Yes*	<input checked="" type="checkbox"/> No
Amplified music?	<input type="checkbox"/> Yes*	<input checked="" type="checkbox"/> No	Games?	<input type="checkbox"/> Yes*	<input checked="" type="checkbox"/> No
Adult Entertainment?	<input type="checkbox"/> Yes*	<input checked="" type="checkbox"/> No	Four or more pool tables?	<input type="checkbox"/> Yes*	<input checked="" type="checkbox"/> No
After hours?	<input type="checkbox"/> Yes*	<input checked="" type="checkbox"/> No			

*May require a Conditional Use Permit

Applicant Narrative:

ARS 4-201-G: In all proceedings before the governing body of a city or town, the Board of Supervisors of a County or the Board, the applicant bears the burden of showing that the public convenience requires and that the best interest of the community will be substantially served by the issuance of this license.

1. I have the capability, qualifications and reliability to hold a liquor license because:

I already own one for the last 15 years.

2. The public convenience requires and the best interest of the community will be substantially served by the issuance of the liquor license because:

To relax & enjoy themselves in such an stressful day, world.

3. Please describe your business:

Mexican Restaurant. You may know it.

The City's forwarding of a recommendation to the AZ Department of Liquor Licenses and Control does not waive and is not a substitute for the Licensee's obligation to comply with all state, local and federal laws, policies and regulations applicable to the license. The Recommendation is not a permit or regulatory approval to hold any events or construct or demolish any improvements. Zoning processes, building permit processes, and similar regulatory requirements may apply to Licensee's contemplated improvements and are completely separate from the Recommendation. Licensee shall be responsible to, separate and apart from this Recommendation, directly obtain all necessary permits and approvals from any and all governmental or other entities including the City's having standing or jurisdiction over the subject areas. For more information regarding zoning processes, building permit processes, and similar regulatory requirements and approvals please call 480-312-2611.

Print Name: Azura Taur Signature: 

Date: 8/30/13

Planning, Neighborhood and Transportation Division

7447 E. Indian School Road, Suite 105, Scottsdale, AZ 85251 • Phone: 480-312-7000 • Fax: 480-312-7088

Arizona Department of Liquor Licenses and Control
800 West Washington, 5th Floor
Phoenix, Arizona 85007
www.azliquor.gov
602-542-5141

APPLICATION FOR LIQUOR LICENSE
TYPE OR PRINT WITH BLACK INK

19-11-2013

Notice: Effective Nov. 1, 1997, All Owners, Agents, Partners, Stockholders, Officers, or Managers actively involved in the day to day operations of the business must attend a Department approved liquor law training course or provide proof of attendance within the last five years. See page 5 of the Liquor Licensing requirements.

SECTION 1 This application is for a:

- ☐ MORE THAN ONE LICENSE
☐ INTERIM PERMIT *Complete Section 5*
☒ NEW LICENSE *Complete Sections 2, 3, 4, 13, 14, 15, 16*
☐ PERSON TRANSFER (Bars & Liquor Stores ONLY)
Complete Sections 2, 3, 4, 11, 13, 15, 16
☐ LOCATION TRANSFER (Bars and Liquor Stores ONLY)
Complete Sections 2, 3, 4, 12, 13, 15, 16
☐ PROBATE/WILL ASSIGNMENT/DIVORCE DECREE
Complete Sections 2, 3, 4, 9, 13, 16 (fee not required)
☐ GOVERNMENT *Complete Sections 2, 3, 4, 10, 13, 15, 16*

SECTION 2 Type of ownership:

- ☐ J.T.W.R.O.S. *Complete Section 6*
☐ INDIVIDUAL *Complete Section 6*
☐ PARTNERSHIP *Complete Section 6*
☐ CORPORATION *Complete Section 7*
☒ LIMITED LIABILITY CO. *Complete Section 7*
☐ CLUB *Complete Section 8*
☐ GOVERNMENT *Complete Section 10*
☐ TRUST *Complete Section 6*
☐ OTHER (Explain) _____

SECTION 3 Type of license and fees LICENSE #(s): 12079635

1. Type of License(s): #12

2. Total fees attached:

\$ 185.00

Department Use Only

APPLICATION FEE AND INTERIM PERMIT FEES (IF APPLICABLE) ARE NOT REFUNDABLE.

The fees allowed under A.R.S. 44-6852 will be charged for all dishonored checks.

SECTION 4 Applicant

1. Owner/Agent's Name: ☐ Mr. Tovar Arucena Espinoza
(Insert one name ONLY to appear on license) Last First Middle
2. Corp./Partnership/L.L.C.: Los Sombrios 2, LLC B1050802
(Exactly as it appears on Articles of Inc. or Articles of Org.)
3. Business Name: Los Sombrios Mexican Restaurant B1034113
(Exactly as it appears on the exterior of premises)
4. Principal Street Location: 14795 N Northsight Blvd Scottsdale Maricopa 85260
(Do not use PO Box Number) (602) City 770-1013 County Zip
5. Business Phone: (480) 991-1799 Daytime Phone: (480) 991-1799 Email: arucenatorovar@msn.com
6. Is the business located within the incorporated limits of the above city or town? ☒ YES ☐ NO
7. Mailing Address: 14795 N Northsight Blvd Scottsdale AZ 85260
City State Zip
8. Price paid for license only bar, beer and wine, or liquor store: Type \$ Type \$

DEPARTMENT USE ONLY

Fees: 100.00
Application

50.00
Interim Permit

35.00
Site Inspection

185.00
Finger Prints

\$ 185.00
TOTAL OF ALL FEES

Is Arizona Statement of Citizenship & Alien Status For State Benefits complete? ☒ YES ☐ NO

Accepted by: EV

Date: 8-26-13

Lic. # 12079635

SECTION 5 Interim Permit:

1. If you intend to operate business when your application is pending you will need an Interim Permit pursuant to A.R.S. 4-203.01.
2. There **MUST** be a valid license of the same type you are applying for currently issued to the location.
3. Enter the license number currently at the location. _____
4. Is the license currently in use? ☐ YES ☐ NO If no, how long has it been out of use? _____

ATTACH THE LICENSE CURRENTLY ISSUED AT THE LOCATION TO THIS APPLICATION.

I, _____, declare that I am the CURRENT OWNER, AGENT, CLUB MEMBER, PARTNER,
 (Print full name)
 MEMBER, STOCKHOLDER, OR LICENSEE (circle the title which applies) of the stated license and location.

X _____
 (Signature)

State of _____ County of _____
 The foregoing instrument was acknowledged before me this

My commission expires on: _____

_____ day of _____
 Day Month Year

 (Signature of NOTARY PUBLIC)

SECTION 6 Individual or Partnership Owners:

EACH PERSON LISTED MUST SUBMIT A COMPLETED QUESTIONNAIRE (FORM LIC0101), AN "APPLICANT" TYPE FINGERPRINT CARD, AND \$22 PROCESSING FEE FOR EACH CARD.

1. Individual:

Last	First	Middle	% Owned	Mailing Address	City State Zip

Partnership Name: (Only the first partner listed will appear on license) _____

General-Limited	Last	First	Middle	% Owned	Mailing Address	City State Zip
<input type="checkbox"/> <input type="checkbox"/>						
<input type="checkbox"/> <input type="checkbox"/>						
<input type="checkbox"/> <input type="checkbox"/>						
<input type="checkbox"/> <input type="checkbox"/>						

) Y R A S S E C E N F I T

2. Is any person, other than the above, going to share in the profits/losses of the business? ☐ YES ☐ NO
 If Yes, give name, current address and telephone number of the person(s). Use additional sheets if necessary.

Last	First	Middle	Mailing Address	City, State, Zip	Telephone#

SECTION 7 Corporation/Limited Liability Co.:

EACH PERSON LISTED MUST SUBMIT A COMPLETED QUESTIONNAIRE (FORM LIC0101), AN "APPLICANT" TYPE FINGERPRINT CARD, AND \$22 PROCESSING FEE FOR EACH CARD.

☐ CORPORATION Complete questions 1, 2, 3, 5, 6, 7, and 8.

☒ L.L.C. Complete 1, 2, 4, 5, 6, 7, and 8.

1. Name of Corporation/L.L.C.: Los Sombros 2, LLC
(Exactly as it appears on Articles of Incorporation or Articles of Organization)

2. Date Incorporated/Organized: 8/16/13 State where Incorporated/Organized: AZ

3. AZ Corporation Commission File No.: 48674911 Date authorized to do business in AZ: _____

4. AZ L.L.C. File No: L18674911 Date authorized to do business in AZ: 8/19/13

5. Is Corp./L.L.C. Non-profit? ☐ YES ☒ NO

6. List all directors, officers and members in Corporation/L.L.C.:

Last	First	Middle	(Title)	Mailing Address	City	State	Zip
Tovar	Azuena	Esperanza	member President	911 N 97th Pl	Scottsdale	AZ	85257

(ATTACH ADDITIONAL SHEET IF NECESSARY)

7. List stockholders who are controlling persons or who own 10% or more:

Last	First	Middle	% Owned	Mailing Address	City	State	Zip
Tovar	Azuena	Esperanza	100	911 N 97th Pl	Scottsdale	AZ	85257

(ATTACH ADDITIONAL SHEET IF NECESSARY)

8. If the corporation/L.L.C. is owned by another entity, attach a percentage of ownership chart, and a director/officer/member disclosure for the parent entity. Attach additional sheets as needed in order to disclose personal identities of all owners.

SECTION 8 Club Applicants:

EACH PERSON LISTED MUST SUBMIT A COMPLETED QUESTIONNAIRE (FORM LIC0101), AN "APPLICANT" TYPE FINGERPRINT CARD, AND \$22 PROCESSING FEE FOR EACH CARD.

1. Name of Club: _____ Date Chartered: _____
(Exactly as it appears on Club Charter or Bylaws) (Attach a copy of Club Charter or Bylaws)

2. Is club non-profit? ☐ YES ☐ NO

3. List officer and directors:

Last	First	Middle	Title	Mailing Address	City	State	Zip

(ATTACH ADDITIONAL SHEET IF NECESSARY)

SECTION 9 Probate, Will Assignment or Divorce Decree of an existing Bar or Liquor Store License:

1. Current Licensee's Name: _____
(Exactly as it appears on license) Last First Middle
2. Assignee's Name: _____
Last First Middle
3. License Type: _____ License Number: _____ Date of Last Renewal: _____
4. ATTACH TO THIS APPLICATION A CERTIFIED COPY OF THE WILL, PROBATE DISTRIBUTION INSTRUMENT, OR DIVORCE DECREE THAT SPECIFICALLY DISTRIBUTES THE LIQUOR LICENSE TO THE ASSIGNEE TO THIS APPLICATION.
-

SECTION 10 Government: (for cities, towns, or counties only)

1. Governmental Entity: _____
2. Person/designee: _____
Last First Middle Contact Phone Number

A SEPARATE LICENSE MUST BE OBTAINED FOR EACH PREMISES FROM WHICH SPIRITUOUS LIQUOR IS SERVED.

SECTION 11 Person to Person Transfer:

Questions to be completed by CURRENT LICENSEE (Bars and Liquor Stores ONLY-Series 06,07, and 09).

1. Current Licensee's Name: _____ Entity: _____
(Exactly as it appears on license) Last First Middle (Indiv., Agent, etc.)
2. Corporation/L.L.C. Name: _____
(Exactly as it appears on license)
3. Current Business Name: _____
(Exactly as it appears on license)
4. Physical Street Location of Business: Street _____
City, State, Zip _____
5. License Type: _____ License Number: _____
6. If more than one license to be transferred: License Type: _____ License Number: _____
7. Current Mailing Address: _____
(Other than business) Street _____
City, State, Zip _____
8. Have all creditors, lien holders, interest holders, etc. been notified of this transfer? ☐ YES ☐ NO
9. Does the applicant intend to operate the business while this application is pending? ☐ YES ☐ NO If yes, complete Section 5 of this application, attach fee, and current license to this application.
10. I, _____, hereby authorize the department to process this application to transfer the
(print full name)
privilege of the license to the applicant, provided that all terms and conditions of sale are met. Based on the fulfillment of these conditions, I certify that the applicant now owns or will own the property rights of the license by the date of issue.
- I, _____, declare that I am the CURRENT OWNER, AGENT, MEMBER, PARTNER
(print full name)
STOCKHOLDER, or LICENSEE of the stated license. I have read the above Section 11 and confirm that all statements are true, correct, and complete.

(Signature of CURRENT LICENSEE)

State of _____ County of _____
The foregoing instrument was acknowledged before me this

Day Month Year

(Signature of NOTARY PUBLIC)

My commission expires on: _____

SECTION 12 Location to Location Transfer: (Bars and Liquor Stores ONLY)

APPLICANTS CANNOT OPERATE UNDER A LOCATION TRANSFER UNTIL IT IS APPROVED BY THE STATE

1. Current Business: Name _____
(Exactly as it appears on license) Address _____
2. New Business: Name _____
(Physical Street Location) Address _____
3. License Type: _____ License Number: _____
4. If more than one license to be transferred: License Type: _____ License Number: _____
5. What date do you plan to move? _____ What date do you plan to open? _____

SECTION 13 Questions for all in-state applicants excluding those applying for government, hotel/motel, and restaurant licenses (series 5, 11, and 12):

A.R.S. § 4-207 (A) and (B) state that no retailer's license shall be issued for any premises which are at the time the license application is received by the director, within three hundred (300) horizontal feet of a church, within three hundred (300) horizontal feet of a public or private school building with kindergarten programs or grades one (1) through (12) or within three hundred (300) horizontal feet of a fenced recreational area adjacent to such school building. The above paragraph DOES NOT apply to:

- a) Restaurant license (§ 4-205.02) c) Government license (§ 4-205.03)
b) Hotel/motel license (§ 4-205.01) d) Fenced playing area of a golf course (§ 4-207 (B)(5))

1. Distance to nearest school: 1.35 miles ft. Name of school Zuni Elementary
Address 9191 E Redfield Rd Scottsdale AZ 85260
City, State, Zip
2. Distance to nearest church: 1.35 miles ft. Name of church Impact Church
Address 1560 N 83rd way Scottsdale AZ 85260
City, State, Zip
3. I am the: ☐ Lessee ☐ Sublessee ☒ Owner ☐ Purchaser (of premises)
4. If the premises is leased give lessors: Name _____
Address _____
City, State, Zip
- 4a. Monthly rental/lease rate \$ _____ What is the remaining length of the lease ___ yrs. ___ mos.
- 4b. What is the penalty if the lease is not fulfilled? \$ _____ or other _____
(give details - attach additional sheet if necessary)
5. What is the total business indebtedness for this license/location excluding the lease? \$ 1,000,000
Please list lenders you owe money to.

Last	First	Middle	Amount Owed	Mailing Address	City State	Zip
Nations	Randy	D	1,000,000	PO Box 2502	Chandler	85244

(ATTACH ADDITIONAL SHEET IF NECESSARY)

6. What type of business will this license be used for (be specific)? Restaurant

SECTION 13 - continued

7. Has a license or a transfer license for the premises on this application been denied by the state within the past one (1) year?

☐ YES ☒ NO If yes, attach explanation.

8. Does any spirituous liquor manufacturer, wholesaler, or employee have any interest in your business? ☐ YES ☒ NO

9. Is the premises currently licensed with a liquor license? ☒ YES ☐ NO If yes, give license number and licensee's name:

License # 12077293 (exactly as it appears on license) Name Randy D. Nations

SECTION 14 Restaurant or hotel/motel license applicants:

1. Is there an existing restaurant or hotel/motel liquor license at the proposed location? ☐ YES ☒ NO
If yes, give the name of licensee, Agent or a company name:

_____ and license #: _____
Last First Middle

2. If the answer to Question 1 is YES, you may qualify for an Interim Permit to operate while your application is pending. Consult A.R.S. § 4-203.01; and complete SECTION 5 of this application.

3. All restaurant and hotel/motel applicants must complete a Restaurant Operation Plan (Form LIC0114) provided by the Department of Liquor Licenses and Control.

4. As stated in A.R.S. § 4-205.02.G.2, a restaurant is an establishment which derives at least 40 percent of its gross revenue from the sale of food. Gross revenue is the revenue derived from all sales of food and spirituous liquor on the licensed premises. By applying for this ☐ hotel/motel ☒ restaurant license, I certify that I understand that I must maintain a minimum of 40 percent food sales based on these definitions and have included the Restaurant Hotel/Motel Records Required for Audit (form LIC 1013) with this application.

X _____
applicant's signature

As stated in A.R.S. § 4-205.02 (B), I understand it is my responsibility to contact the Department of Liquor Licenses and Control to schedule an inspection when all tables and chairs are on site, kitchen equipment, and, if applicable, patio barriers are in place on the licensed premises. With the exception of the patio barriers, these items are not required to be properly installed for this inspection. Failure to schedule an inspection will delay issuance of the license. If you are not ready for your inspection 90 days after filing your application, please request an extension in writing, specify why the extension is necessary, and the new inspection date you are requesting. To schedule your site inspection visit www.azliquor.gov and click on the "Information" tab.

X _____
applicant's initials

SECTION 15 Diagram of Premises: (Blueprints not accepted, diagram must be on this form)

1. Check ALL boxes that apply to your business:

☒ Entrances/Exits ☒ Liquor storage areas Patio: ☒ Contiguous
☐ Service windows ☐ Drive-in windows ☐ Non Contiguous

2. Is your licensed premises currently closed due to construction, renovation, or redesign? ☐ YES ☒ NO
If yes, what is your estimated opening date? 08/20/2013
month/day/year

3. Restaurants and hotel/motel applicants are required to draw a detailed floor plan of the kitchen and dining areas including the locations of all kitchen equipment and dining furniture. Diagram paper is provided on page 7.

4. The diagram (a detailed floor plan) you provide is required to disclose only the area(s) where spirituous liquor is to be sold, served, consumed, dispensed, possessed, or stored on the premises unless it is a restaurant (see #3 above).

5. Provide the square footage or outside dimensions of the licensed premises. Please do not include non-licensed premises, such as parking lots, living quarters, etc.

As stated in A.R.S. § 4-207.01(B), I understand it is my responsibility to notify the Department of Liquor Licenses and Control when there are changes to boundaries, entrances, exits, added or deleted doors, windows or service windows, or increase or decrease to the square footage after submitting this initial drawing.

X _____
applicant's initials

SECTION 15 Diagram of Premises

4. In this diagram please show only the area where spirituous liquor is to be sold, served, consumed, dispensed, possessed or stored. It must show all entrances, exits, interior walls, bars, bar stools, hi-top tables, dining tables, dining chairs, the kitchen, dance floor, stage, and game room. Do not include parking lots, living quarters, etc. When completing diagram, North is up ↑.

If a legible copy of a rendering or drawing of your diagram of premises is attached to this application, please write the words "diagram attached" in box provided below.

13 AUG 26 197. LIC. RM11110

SECTION 16 Signature Block

I, Ariana Espinoza TDVW, hereby declare that I am the OWNER/AGENT filing this application as stated in Section 4, Question 1. I have read this application and verify all statements to be true, correct and complete.

X _____
(signature of applicant listed in Section 4, Question 1)

State of AZ County of Maricopa

The foregoing instrument was acknowledged before me this

26th of August 2013
Day Month Year

Ariel Morin
Signature of NOTARY PUBLIC

My commission expires on :



②
~~Living Floor Plan~~

4021 1207

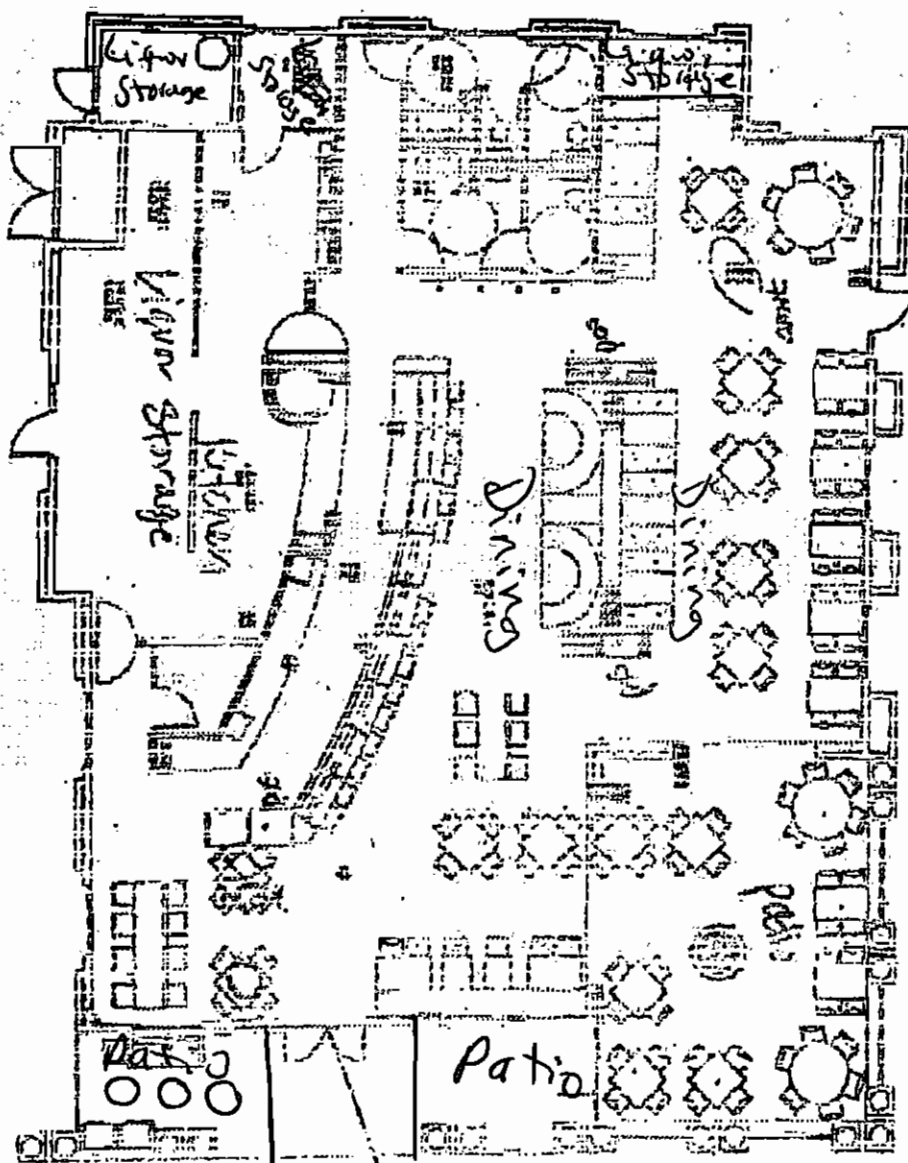

13 AUG 26 197. LIC #11110

07 AUG 20 197. LIC #4 (6)

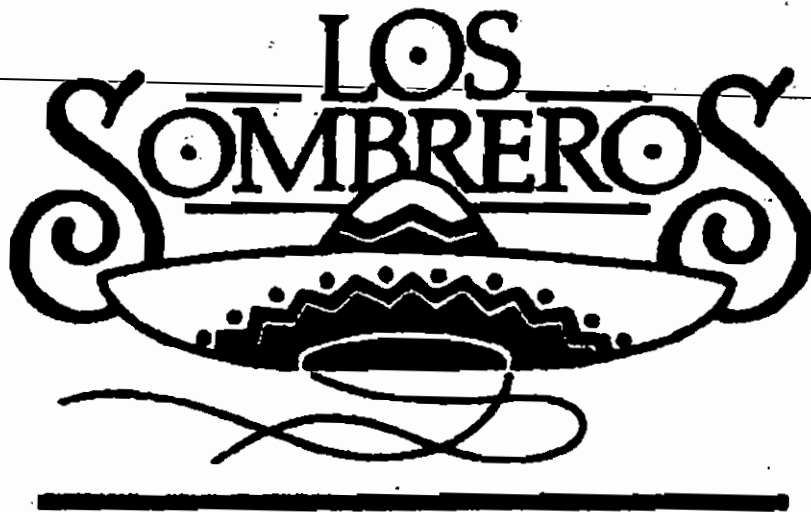

Lunch Specials

(From Noon to 3 pm)

Entrees \$9.95

(All served with rice or refried beans)

Chicken enchilada with tomatillo sauce and chipotle crema.

Chicken Enmolada.

Chile relleno with 3 choices: chicken picadillo, beef picadillo or cheese.

Chicken Chilaquiles with epazote roasted tomato sauce.

TACO Menu

Pork Carnitas (2)

Chicken Crispy Dorados (2)

Beef Carne Asada (2)

Seafood (2)

Crispy Potato (3)

Crispy Hibiscuses (3)

Crispy Beef picadillo (3)



13 AUG 26 1991 Lic. #M11111



13 AUG 26 1974

Antojitos

GUACAMOLE

Small \$6.95 Large \$10.95

QUESO FUNDIDO

Crab \$12.95

Shrimp \$12.95

Rajas \$9.95

Huitlacoche \$10.95

Spinach \$10.95

Chorizo and black beans \$10.95

QUESADILLAS \$7.95

(Mexico City style)

Chicharron en salsa verde and refried black beans (2)

Picadillo, sweet ground beef (2)

Hibiscus con salsa verde and crema (2)

Huitlacoche with goat cheese and chipotle tomato sauce (2)

TAQUITOS

Grilled Rib eye served with pico de gallo, soft (3) \$10.95

Seafood, fish and shrimp, soft (3) \$10.95

Chicken, crispy (3) \$8.95

Potato, crispy (3) \$6.95

Hibiscuses (crispy) \$5.95

Mushrooms & Bacon with onions and cream, soft (3) \$6.95

Picadillo, sweet, ground beef & crispy (3) \$8.95

HUITLACOCHÉ CREPAS \$9.95

Served with goat & blue cheese & pomegranate sauce (2)

CORN CAKE SOUFFLE \$5.95

With mole poblano.

SALADS:

Fig and Panela Cheese \$6.95

With greens in a balsamic vinaigrette dressing.

Jicama & Orange \$6.95

With a chile lime dressing.

Tomato with Oaxaca cheese and pumpkin seeds in a cider vinaigrette \$6.95

Shrimp Jicama Tostada

Greens with mango dressing \$11.95

Shrimp and Papaya

With greens and honey lime dressing \$11.95

Crab & Mango \$12.95

Served with honey-lime vinaigrette.

Greens with grilled chicken or beef and apples, dry cranberries, Oaxaca cheese, pumpkinseeds and jalapeños in a vinaigrette \$14.95

SOUPS

Tortilla or Pork Pozole

Cup \$4.95 bowl \$6.95

CHIPS AND SALSA \$3.95

Not split checks thank you.

18% gratuity will be added to parties of 5 or more.



13 AUG 26 11:11 AM

PLATOS FUERTES

Entrees

Served with two choices of: Rice, Refried Beans, Black Beans or sautéed seasonal vegetables.

ECHILADA PLATES

De la Plaza Cheese, served with carrots and potatoes with guajillo red sauce (2) \$14.95

Hibiscus with salsa verde, crema blanca and refried black beans (2) \$15.95

Chicken Enmoladas with mole poblano sauce (2) \$17.95

Smoked Chicken with salsa verde and chipotle crema (2) \$17.95

Duck with Mole Nayarit baked and shredded duck (2) \$19.95

Crab with roasted tomato chipotle sauce (2) \$21.95

CHILE RELLENOS \$16.95
The traditional with two cheeses and corn (2)

Chicken picadillo with almonds in a pork rind cream sauce (2)

Ground Beef Picadillo with olives, apricots & raisins

(One of each, add \$2 more)

PECHUGA RELLENA

Grilled chicken breast stuffed with goat cheese and huitlacoche in a chipotle tomato sauce \$19.95

POLLO CON

ESPINACAS \$19.95

Grilled chicken breast in a chipotle-spinach cream sauce.

SNAPPER \$21.95

Esquites: grilled corn, chipotle cream on balsamic honey.

SALMON with mango pico de gallo \$21.95

TROUT with almonds in a lemon butter with capers \$21.95

CREPAS DE

MARISCOS \$22.95

With fish, shrimp & crab.

CAMARONES AL

TEQUILA

Al ajillo with bacon and chipotle cream sauce \$21.95

Pork old favorites \$18.95

- ❖ Carnitas or
- ❖ Puerco en Chipotle

ALCAPARRADO \$19.95

Baby back ribs and chicken, in a caper-tomatillo sauce.

PORK LOIN \$18.95

Served with tamarind mole.

LAMB ADOBO

Braised lamb shank in a sweet and spicy ancho chile sauce \$21.95

*Rib eye \$32.95

- ❖ With chile negro
- ❖ Chipotle cream sauce, onions, mushrooms and jalapeños.

* (these items are cooked to order)

*13 AUG 26 1997. LSC RM1111



13 AUG 26 149. Lic. 0011-11

Refrescos \$2.95

Coke, Diet Coke, Sprite, Mr. Pibb, Orange Soda, Iced Tea, Milk (free refills)

Homemade Fresh \$2.95

Limeade, Hibiscus Tea or Tamarind (one free refill)

Juices \$2.95

Apple, Orange, Pineapple, Grapefruit, Cranberry (no refills)

- ❖ Hot Tea, Coffee \$2.95
- ❖ Hot Chocolate \$3.95
- (With Almendrado tequila) \$7.50



MARGARITAS

BLANCO TEQUILAS

Well Margarita

Centenario azul, triple sec, and sour mix
\$ 6.95

Patron Silver \$10.95

Citronge liqueur and Fresh lime mix

El Tesoro Blanco \$9.95

Gran Gala, and fresh lime mix

REPOSADO TEQUILAS

House special

Cuervo tradicional, triple sec and
fresh lime mix \$ 8.95

Sauza Hornitos

Triple Sec, and fresh lime mix \$8.95

ANEJO TEQUILAS

Cadillac Margarita

Chinaco, cointreau,
lime & orange juices \$9.95

Pueblo Viejo

Dos Manos Tequila, Gran Gala and
fresh lime mix \$9.95

Tres Generaciones

Gran Gala, and
fresh lime mix \$9.95

SPECIALTY MARGARITAS & DRINKS

La Damiana

Sauza Hornitos Tequila, Damiana
aphrodisiac liqueur, and fresh lime
\$ 9.95

Margarita de Coco

Cuervo Traditional Tequila, Kalani
coconut liqueur, and pineapple juice
\$ 9.95

Tijuana Donke

Cazadores Silver Tequila
Ginger beer and Fresh Lime \$8.95

Margarita centenarioAzul

Pomegranate juice & liquor \$9.95

Mojito

Bacardi rum, fresh lime juice & mint \$8.95

ALL OUR TEQUILAS ARE 100 % BLUE AGAVE

13 AUG 20 Liqueur Lic. #11111

Los Sombreros

Children's Menu

(Under 12 or \$3 up charge)

Kid's Quesadilla \$1.95

Corn tortilla with melted jack cheese

Bean Tacos \$3.95

Served with rice

Taco \$4.95

Beef or chicken. Served with rice or beans

Cheese Enchilada \$4.95

With red chile sauce. Served with rice and beans

Chilaquiles de Refritos \$4.95

Softened tortilla strips with refried beans and melted jack cheese

Ensalada \$4.95

Small mixed greens and vegetables salad with salsa dressing

Small Scoop of Ice cream \$2.50

Vanilla or chocolate

13 AUG 26 1994 L.C. 011111

Los Sombreros

Children's Menu

(Under 12 or \$3 up charge)

Kid's Quesadilla \$1.95

Corn tortilla with melted jack cheese

Bean Tacos \$3.95

Served with rice

Taco \$4.95

Beef or chicken. Served with rice or beans

Cheese Enchilada \$4.95

With red chile sauce. Served with rice and beans

Chilaquiles de Refritos \$4.95

Softened tortilla strips with refried beans and melted jack cheese

Ensalada \$4.95

Small mixed greens and vegetables salad with salsa dressing

Small Scoop of Ice cream \$2.50

Vanilla or chocolate

13 AUG 26 1974. Lic. #11111

13 AUG 26 LIG. Lic. #11111

ANEJO

EL TESORO	\$8.95
CAZADORES	\$9.95
CHINACO	\$9.95
DON JULIO	\$9.95
HERRADURA	\$9.95
TRES GENERACIONES	\$9.95
MILAGO	\$9.95
PARTIDA	\$9.95
PATRON	\$10.95
CABO WABO	\$10.95
SIETE LEGUAS	\$11.95
TEQUILA REAL ANEJO	\$12.95
CORZO	\$15.95
1921	\$19.95

WILD AGAVE SPIRITS

SOTOL BLANCO	\$8.95
SOTOL REPOSADO	\$9.95
SOTOL ANEJO	\$10.95

NOTABLE AND SUPER PREMIUM

1921 CREMA	\$4.95
ROSEANGEL	\$9.95
MILAGO BARREL SELECT	\$13.95
MAESTRO DOBEL DIAMOND	\$14.95
CASA NOBLE ANEJO	\$16.95
TEQUILA REAL EXTRA ANEJO	\$19.95
DON JULIO 1942	\$19.95
CLASE AZUL REPOSADO	\$19.95
EL TESORO PARADISO ANEJO	\$21.95
CHINACO NEGRO	\$24.95
PATRON PLATINUM	\$24.95
HERRADURA SELECCION SUPREMO	\$45.00

MEZCAL

TEQUILAS

These Tequilas are 100% blue agave with sangrita chaser.

BLANCO

AZUL	\$5.50
CAZADORES	\$7.50
TEQUILA REAL SILVER	\$7.95
DON JULIO	\$7.95
EL TESORO	\$7.95
HERRADURA	\$7.95
CENTENARIO	\$7.95
CHINACO	\$7.95
MILAGRO	\$7.95
PARTIDA	\$7.95
CABO WABO	\$8.95
TRES GENERACIONES	\$9.95
TEQUILA OCHO	\$10.95
CASA NOBLE	\$11.95
CLASE AZUL	\$12.95
DON JULIO 70 TH ANIVERSARY	\$12.95

REPOSADO

CUERVO TRADITIONAL	\$6.95
SAUZA HORNITOS	\$6.95
CAZADORES	\$7.95
EL TESORO	\$8.95
HERRADURA	\$8.95
CHINACO	\$8.95
MILAGO	\$8.95
PARTIDA	\$8.95
DON JULIO	\$8.95
TEQUILA REAL REPOSADO	\$9.95
PATRON	\$9.95
SIETE LEGUAS	\$9.95
CASTA	\$10.95
CABO WABO	\$10.95
CRUZ	\$10.95
CASA NOBLE	\$12.95

13 AUG 26 197. 112. 811111

After Dinner Drinks

Rompopo

10 year old Mexican rum, almendrado & vanilla cream served on the rocks \$7.95

El Sombrero

Kahlua & cream \$6.95

Mexican Coffee

Coffee, kahlua, and tequila \$6.95

El Jardin

Coffee, almendrado tequila, and baileys \$6.95

Mexican Hot Chocolate

Ibarra chocolate and almendrado tequila \$6.95

After Dinner Liquor & Liqueurs

Agavero chilled tequila liqueur \$7.95

Almendrado Tequila

Almond flavored blue agave tequila \$6.95

Ruby Port Graham's six grapes \$7.95

Tawny Port Benjamin \$8.95

Patron xo Chilled Coffee tequila \$6.95

Kahlua Coffee Liqueur \$6.95

Grand Marnier \$8.95

1921 crema de tequila \$4.95

Homemade Desserts

Chocolate Ice Cream (home made) \$5.95

Vanilla Ice Cream (home made) \$5.95

Flan \$6.95

With Almendrado Tequila \$8.95

Mexican Chocolate Cream Pie \$6.95

Tamal de Chocolate \$6.95

Flanecito \$5.50

10 flavors (please ask your server which ones are available)

coffee and baileys, damiana, kahlua, almendrado, yucateco, elote, cajeta, passion fruit, chocolate and naranja.

13 AUG 26 1994 LIC. M11111