

SHOWER RECEPTORS BUILT DIRECTLY ON GROUND SHALL:

- A) BE WATERTIGHT.
- B) BE CONSTRUCTED OF APPROVED TYPE DENSE, NON-ABSORBENT AND NON-CORROSIVE MATERIALS.
- C) BE ADEQUATELY REINFORCED.
- D) BE PROVIDED WITH AN APPROVED FLANGED FLOOR DRAIN MADE OF CAST IRON, BRASS OR OTHER APPROVED MATERIAL DESIGNED TO MAKE WATERTIGHT JOINT IN FLOOR.
- E) HAVE SMOOTH, IMPERVIOUS AND DURABLE SURFACES.
- F) HAVE CURBS EXTENDING AT LEAST (3) INCHES ABOVE THE FINISHED TRESHOLD BEFORE ANY WOOD SUPERSTRUCTURE MAY BE ADDED.

SHOWER RECEPTORS BUILT DIRECTLY ON GROUND SHALL:

- A) BE WATERTIGHT.
- B) BE CONSTRUCTED OF APPROVED TYPE DENSE, NON-ABSORBENT AND NON-CORROSIVE MATERIALS.
- C) BE ADEQUATELY REINFORCED.
- D) BE PROVIDED WITH AN APPROVED FLANGED FLOOR DRAIN MADE OF CAST IRON, BRASS OR OTHER APPROVED MATERIAL DESIGNED TO MAKE WATERTIGHT JOINT IN FLOOR.
- E) HAVE SMOOTH, IMPERVIOUS AND DURABLE SURFACES.
- F) HAVE CURBS EXTENDING AT LEAST (3) INCHES ABOVE THE FINISHED TRESHOLD BEFORE ANY WOOD SUPERSTRUCTURE MAY BE ADDED.

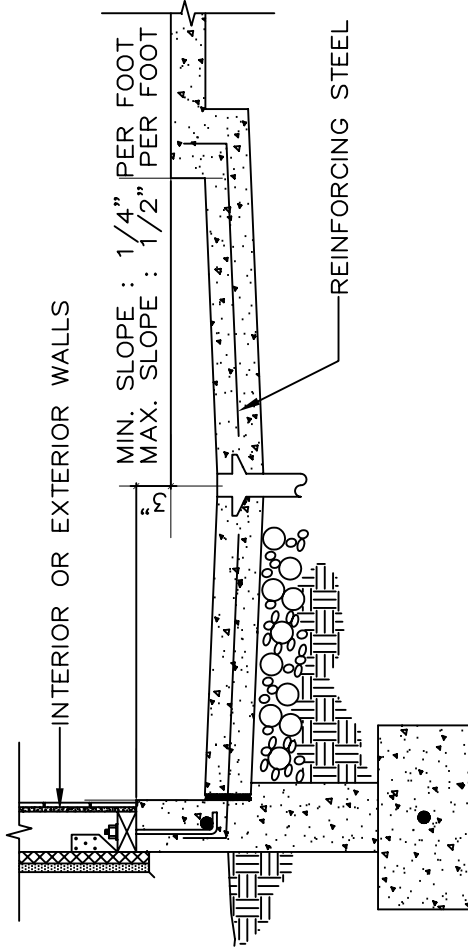

APPROVED PVC&PE SHEET LINING MIN.040 INCH THICK, AND INSTALLED PER MFR. INSTRUCTIONS. LEAKTEST IS REQUIRED BY CITY INSPECTOR.

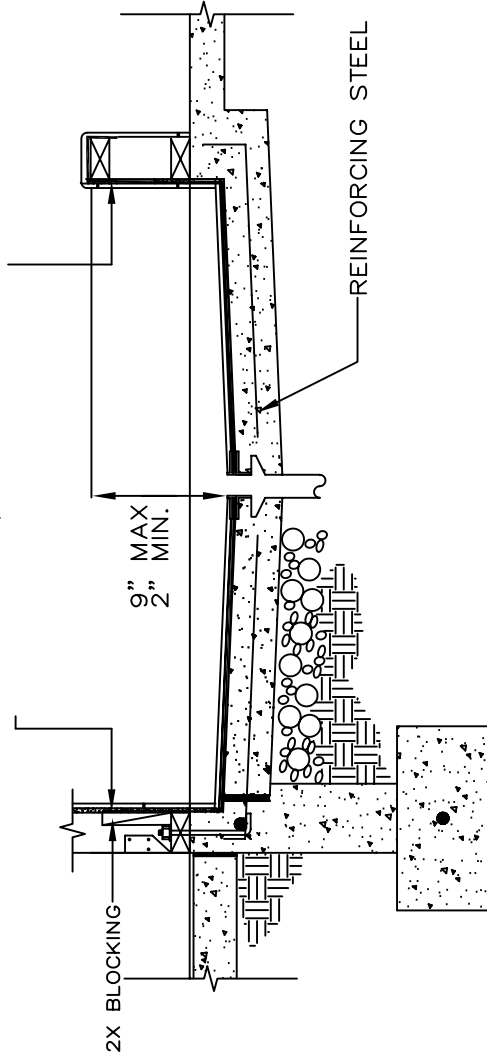

SHOWER BASE WITH CURB
1" = 1'-0"

SHOWER BASE WITH MEMBRANE
1" = 1'-0"