

Exterior Wall Footing Example

ABBREVIATIONS

PRESS. = PRESSURE TREATED

O.C. = ON CENTER

W/N = WITHIN

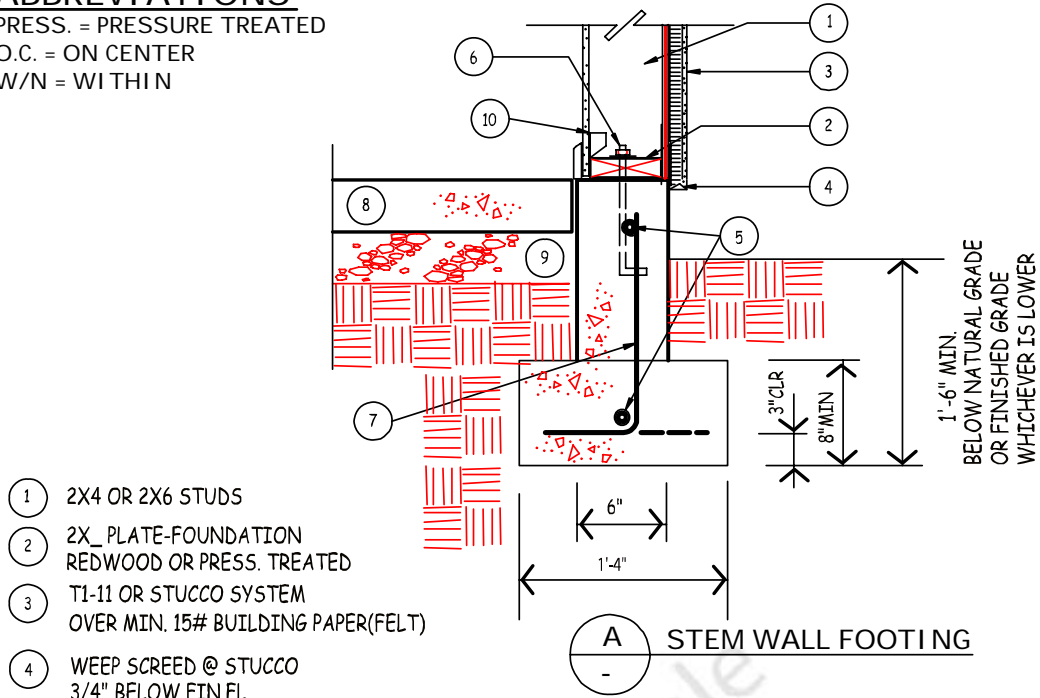

- 1 2X4 OR 2X6 STUDS
- 2 2X PLATE-FOUNDATION
REDWOOD OR PRESS. TREATED
- 3 T1-11 OR STUCCO SYSTEM
OVER MIN. 15# BUILDING PAPER(FELT)
- 4 WEEP SCREED @ STUCCO
3/4" BELOW FIN.FL.
- 5 #4 CONT. TOP & BOT.
- 6 1/2"X10" ANCHOR BOLT, 7" MIN. EMBED.
@ 48" O.C. & W/N 12" OF PLATE ENDS
- 7 #4 @48" O.C.
ALT. BEND
- 8 2500 PSI CONCRETE
- 9 4" COMPACTED ABC
- 10 H2.5 ALT. STUDS

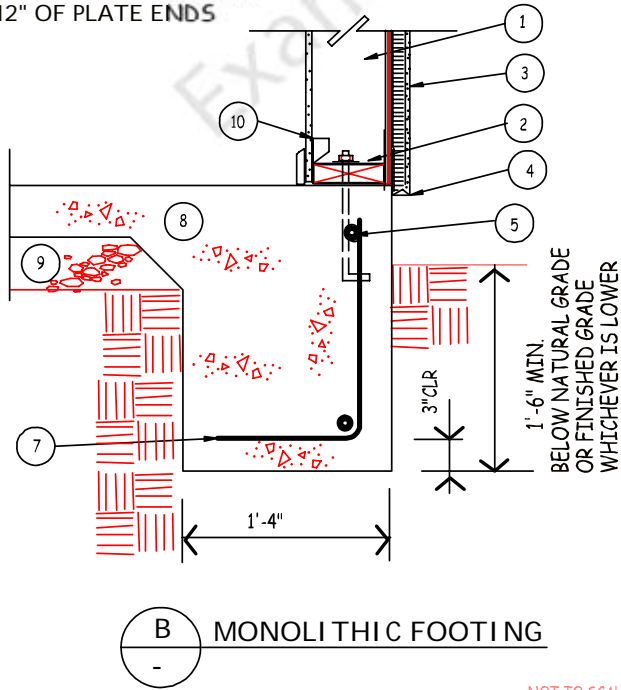

NOT TO SCALE

Figure is for example purposes only.