

4. Masterplan

Design Concept Report: Overall Site Plan

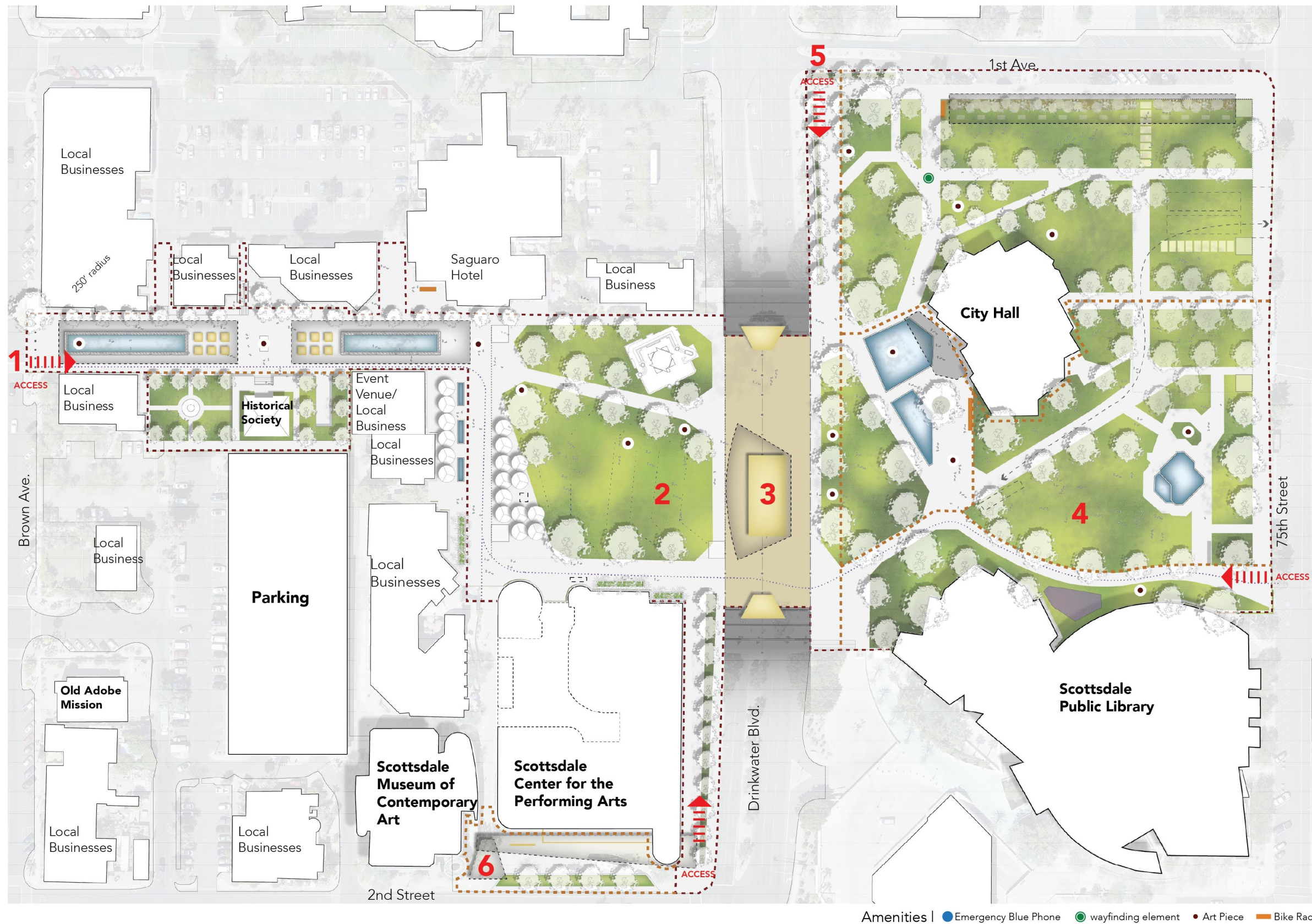

Focus Areas

- 1. West Entrance Improvements**
 - The West Entrance area is designed as a transition between Main Street and the Civic Center Campus. Design Improvements allow for visual connection into the Civic Center, going back to street level grading, improving accessibility.
- 2. Center Lawn**
 - The Center Lawn serves as the main public event space in the Civic Center for performances, outdoor gathering, festivals, picnics and special programs.
- 3. Bridge Pavillion**
 - The Bridge Pavillion acts as both a linear walkway through the park and a performance space for Central Lawn. Program elements include an event stage, public restrooms, and storage space.
- 4. East Lawn**
 - The East Lawn is located in front of/to the North Scottsdale Public Library and it conserves the majority of the existing infrastructure. The existing lawn remains in place for smaller events and local neighborhood activities.
- 5. Northeast Entrance**
 - Currently an open parking lot, the north east portion of the Civic Center is a key point of entry to the campus. Existing parking would go underground allowing for better pedestrian access and greater open public space..
- 6. Second Street Entrance**
 - The Second Street Entrance allows for greater access and visibility for both pedestrian and vehicular traffic entering the Civic Center complex from the south. The drop-off includes multiple lanes for ease of use, a shade canopy and new signage to promote performances and events.